

* All images are for illustrative purposes only.

UHD Signage UL3G Series

LG UHD Signage



Superb Picture Quality



webOS Smart Platform



Meeting Room Solution



Convenient Maintenance

FULL HD ULTRA HD



H.264 HEVC

ULTRA HD Resolution

With the resolution that is 4 times higher than FHD, it makes the color and details of the content more vivid and realistic. In addition, the wide viewing angle applied with the LG IPS Panel, provides clear content with no distortion.

High Efficiency Video Coding

The UL3G series supports HEVC which efficiently compresses/decompresses high-capacity UHD content, playing ultra-high quality videos with half the network traffic than the existing H.264 codec.

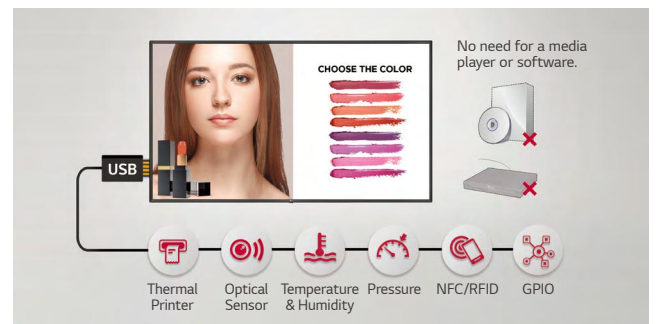

High Performance SoC with webOS

Built-in SoC can execute several tasks at once while providing smooth content playback without the need for a media player. Also, the LG webOS smart signage platform enhances user convenience with intuitive GUI and simple app development tools.

Various Sensor Applications

The LG webOS smart signage platform easily supports connections with external sensors via USB plug-in. The overall cost for maintenance is reduced as there's no need to purchase additional software or media players for creating value-added solutions.



Content Sharing

Content Mirroring among devices is more convenient on a Wi-Fi network.

Real-time Promotion

With Beacon and BLE (Bluetooth Low Energy), shop managers can provide coupons and information in real-time.

Wireless Solution

The UL3G series operates as a virtual router which can be a wireless access point for mobile devices.



Compatibility with AV Control System

The UL3G series has been certified Crestron Connected® for high compatibility with professional AV controls to achieve seamless integration and automated control*, boosting business management efficiency.

* Network based control



Compatibility with Conferencing System

For the optimum visual meeting, the UL3G series has certified its compatibility with Cisco System that offers powerful and integrated control* for a smarter video conference, eliminating a waste of time for setting up the picture quality or changing input on incoming calls.

* Using an HDMI cable connection

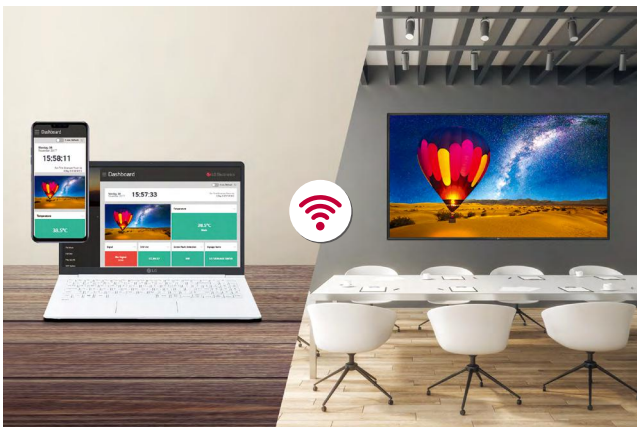

Remote Monitoring and Control

Through the Control Manager, the embedded web monitoring solution, you can control and monitor the status of multiple UL3G series displays in different locations in real-time. It is available on internet connected devices, allowing you to flexibly and rapidly respond to emergency situations anywhere.

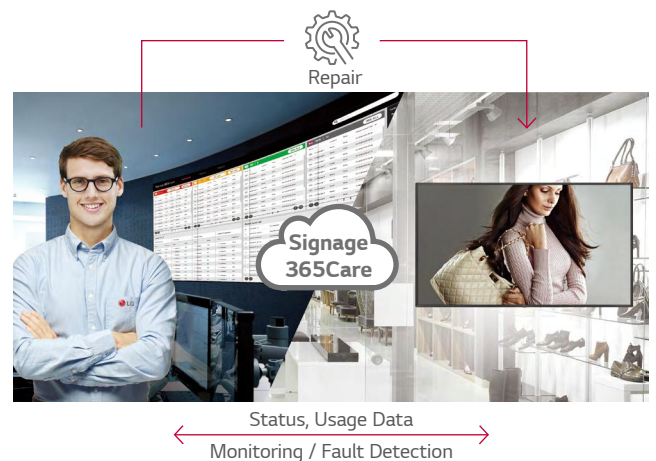

Real-time Care Service with LG Signage365Care

The maintenance gets easier and faster with an optional service Signage365Care*, a cloud service solution provided by LG service. It remotely manages status of displays in client workplaces for fault diagnosis and remote-control services, ensuring the stable operation of a client's business.

* The availability of "Signage365Care" service can differ by region, so please contact the LG sales representative in your region for further details.

DIMENSION

(unit: mm)

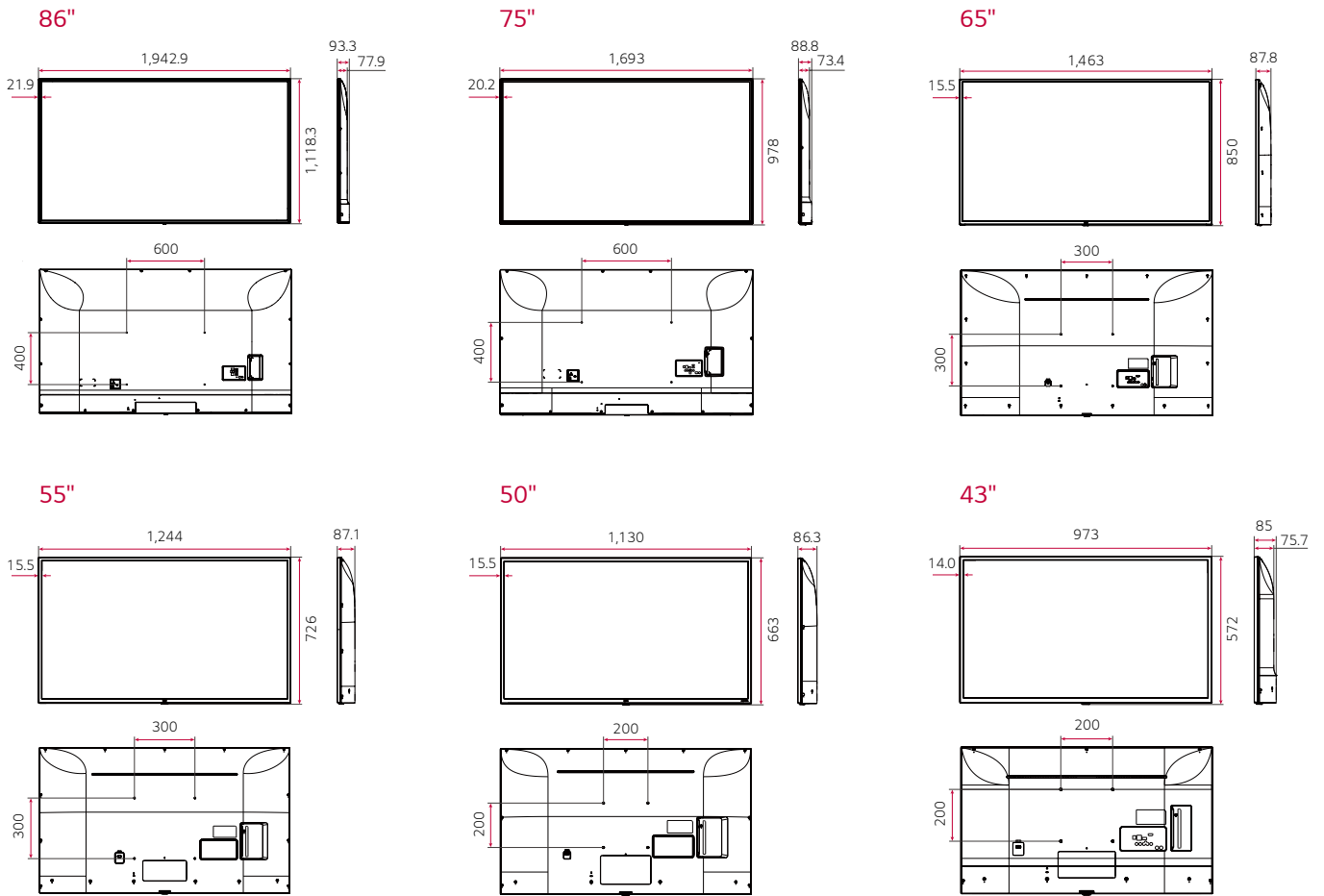

CONNECTIVITY

Rear

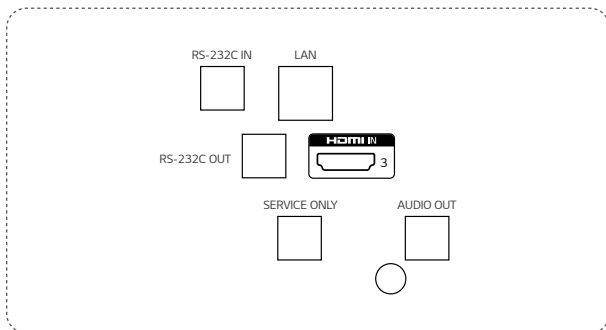

Side



* Dimensions & Jack Panels may differ from the above image, so please contact LG sales team to verify before ordering.



Download
 LG C-Display+
 Mobile App
 Google Play Store

- www.lg.com/global/business/information-display
- www.youtube.com/c/LGCommercialDisplay
- www.facebook.com/LGInformationDisplay
- www.linkedin.com/company/lginformationdisplay
- twitter.com/LG_ID_HQ

LG may make changes to specifications and product descriptions without notice. Copyright © 2020 LG Electronics Inc. All rights reserved. "LG Life's Good" is a registered trademark of LG Corp. The names of products and brands mentioned here may be the trademarks of their respective owners.

