

MC92N0-G

QUICK START GUIDE

<http://www.zebra.com/mc92n0-g>

See User Guide for more information

BATTERY INSERTION

Front View

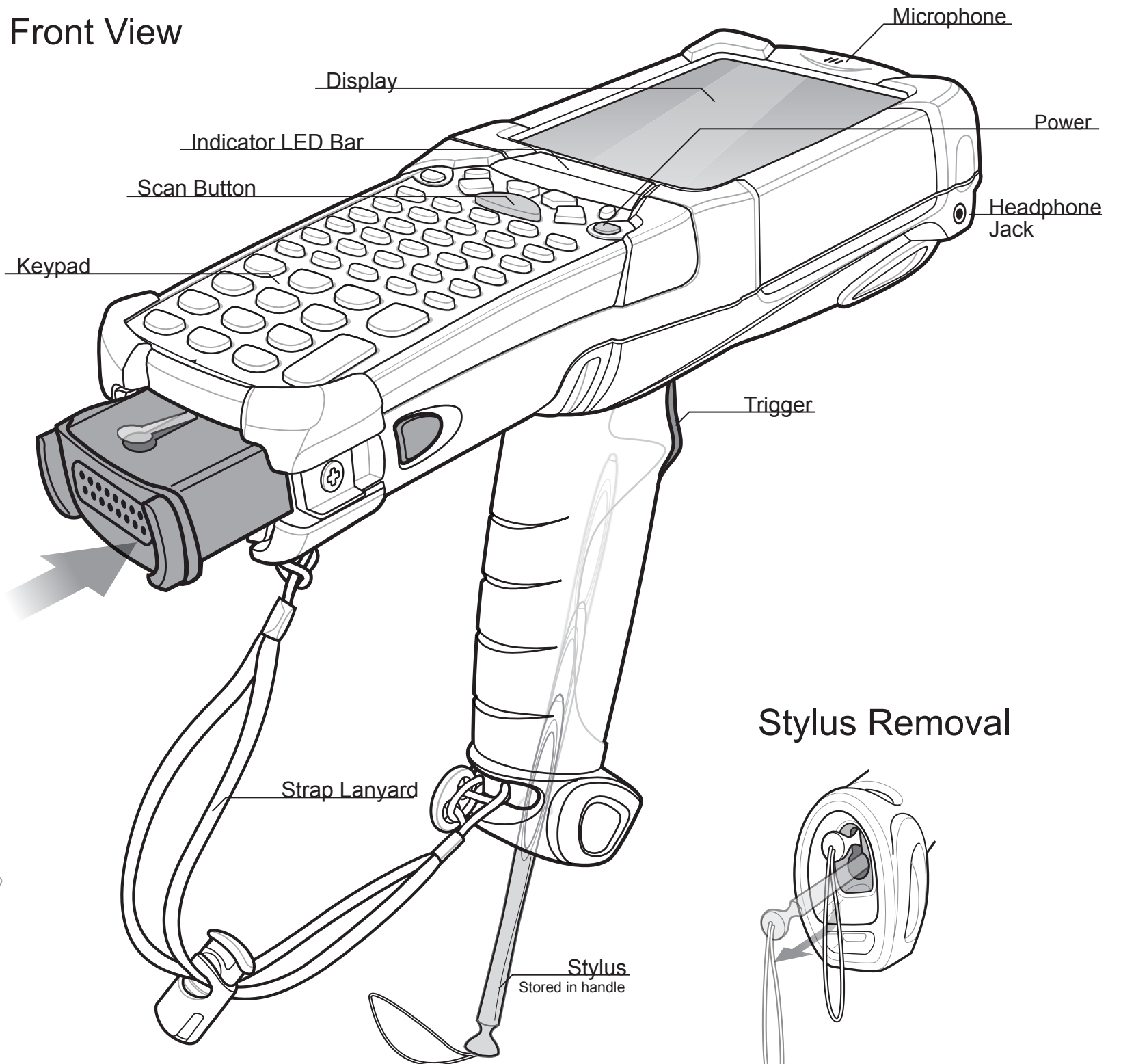

Battery Removal

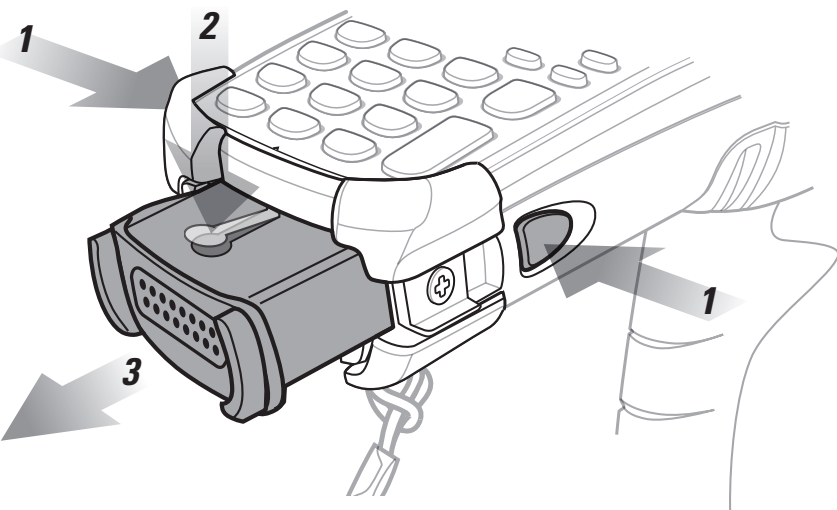

Stylus Removal

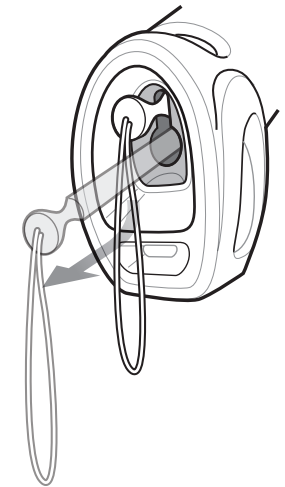

SNAP-ON ACCESSORY INSTALLATION

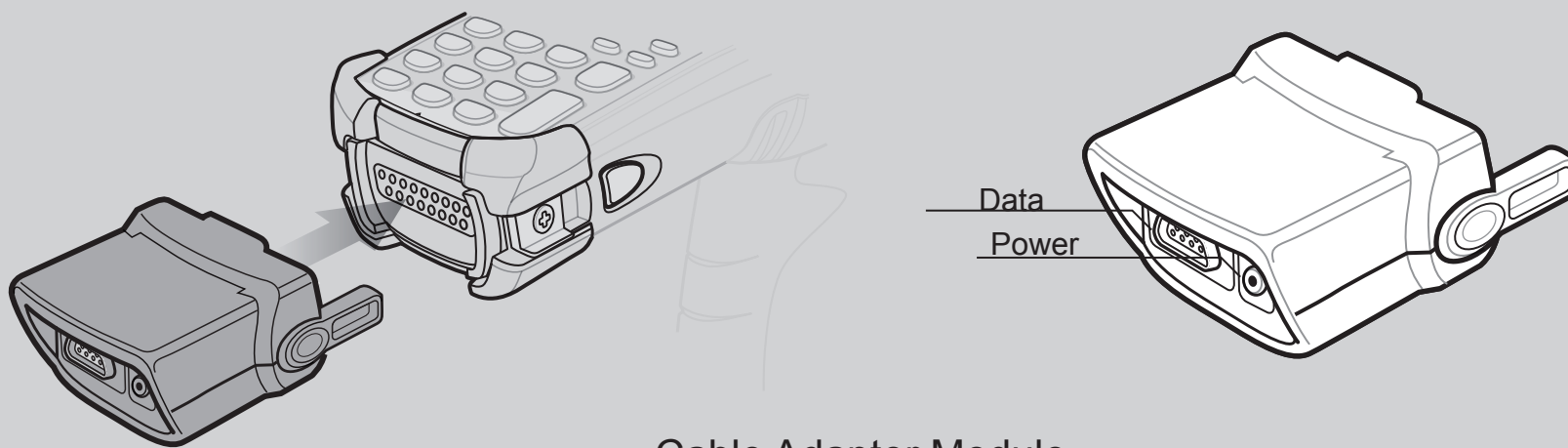

Cable Adapter Module

CHARGING INSTRUCTIONS

⦿ = LED Indicator Location Slow Flash = Normal Charge Solid Amber = Full Charge Fast Flash = Charging Error

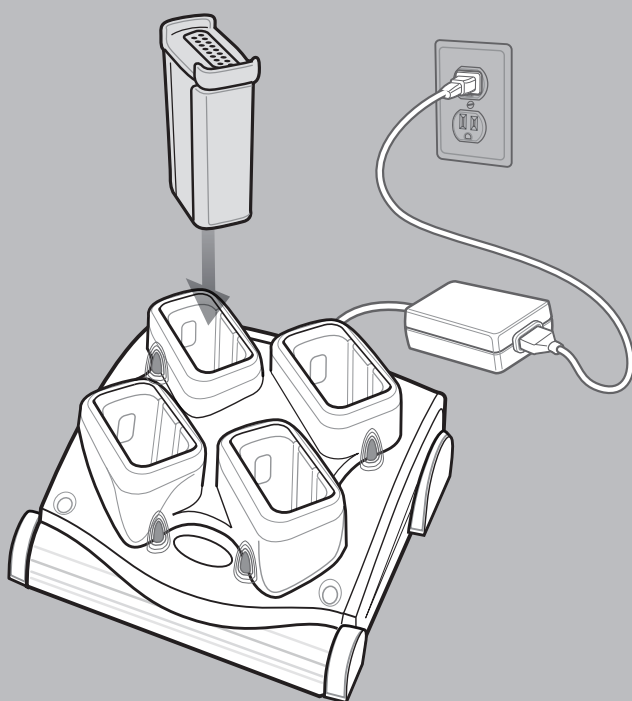

Four Slot Spare Battery Charger

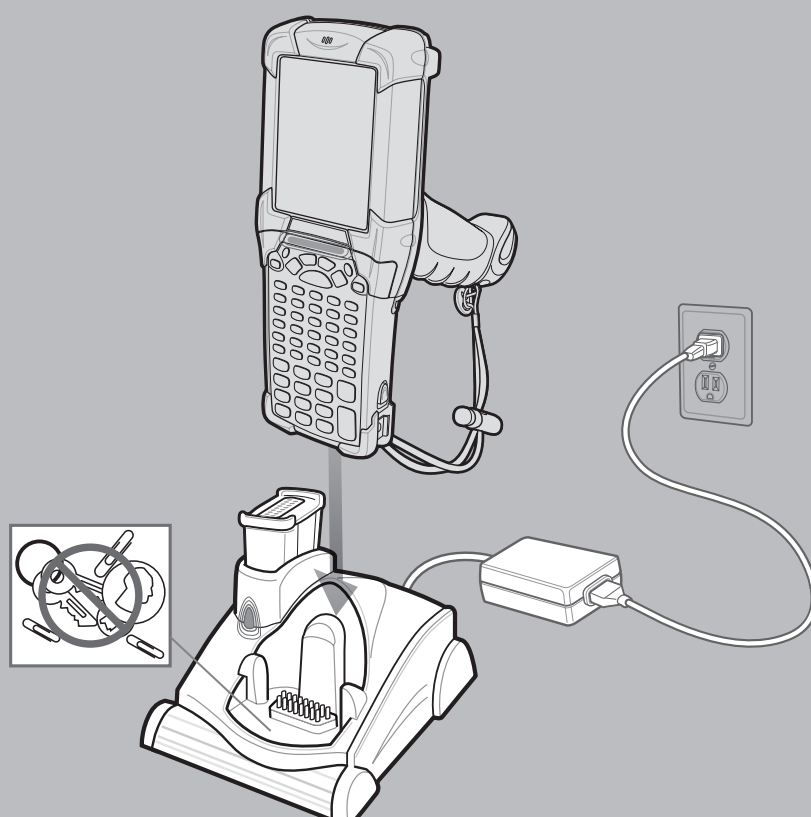

Single Slot Serial/USB Cradle

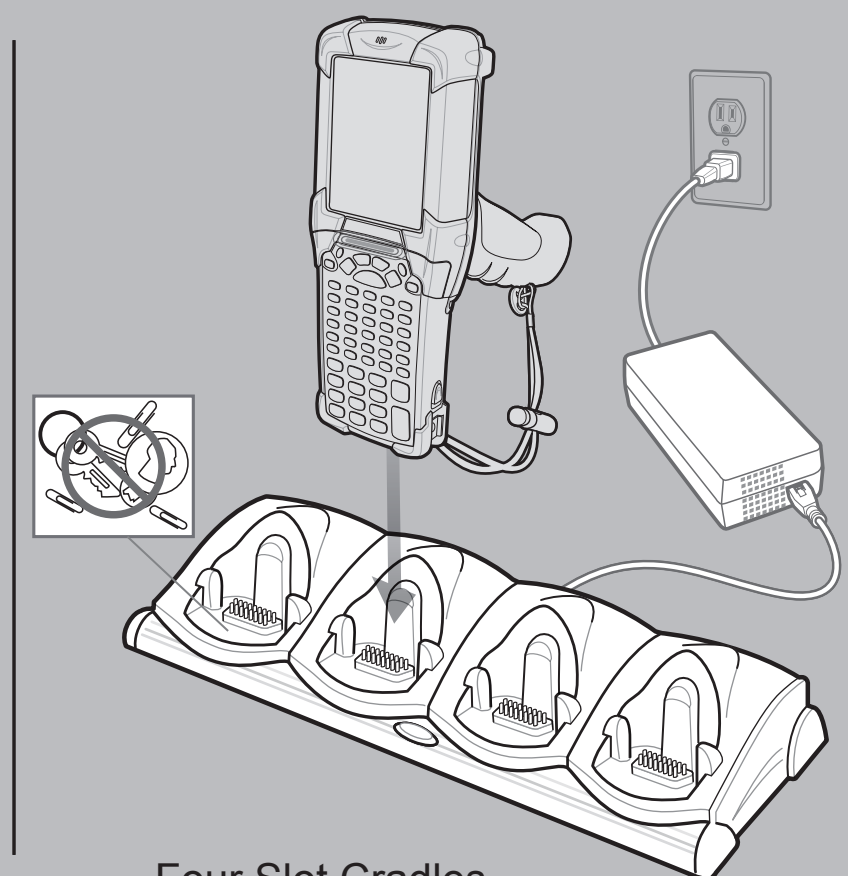

Four Slot Cradles
Charge-Only Cradle and Ethernet Cradle

POST IN WORK AREA

OPTIMUM IMAGING AND SCANNING POSITIONS

Laser Scanning

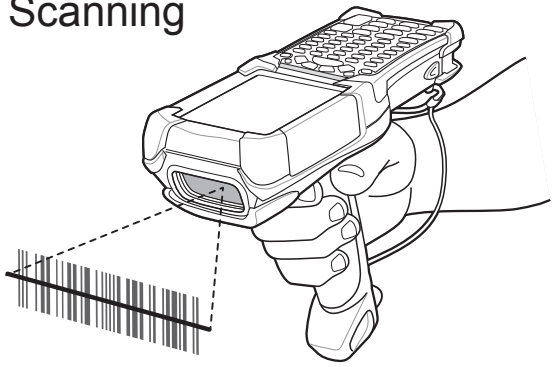

Standard Range Imaging

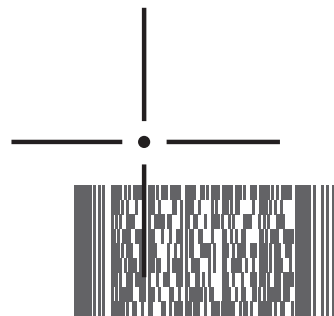
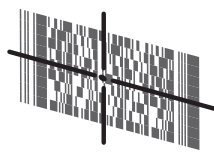
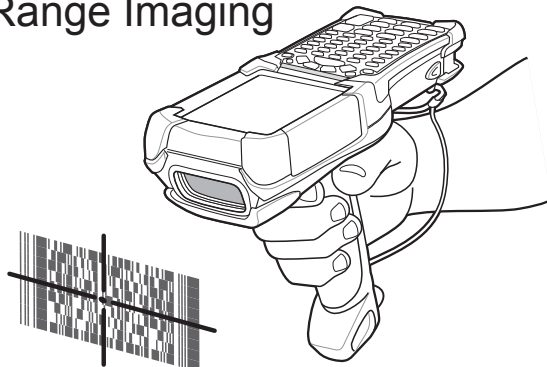

Long Range Imaging

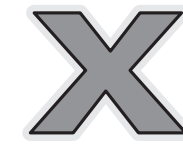
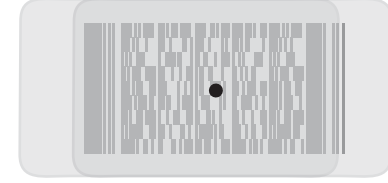
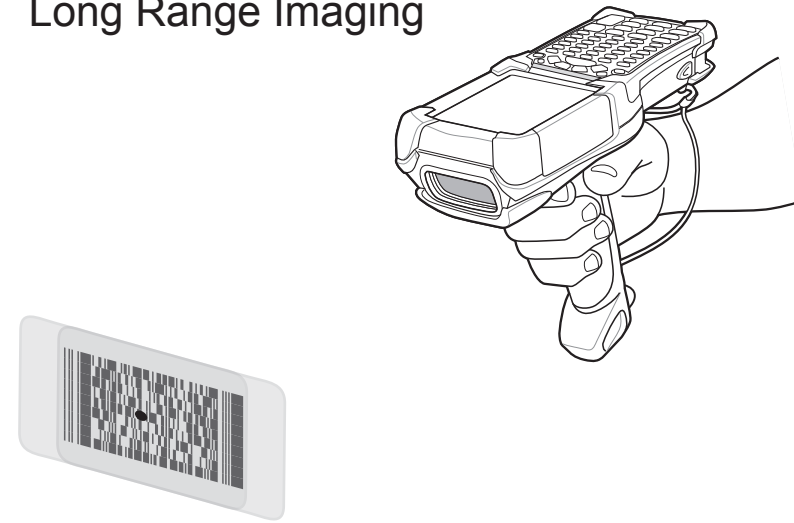

OPTIMUM UPRIGHT BODY POSTURE



AVOID EXTREME WRIST ANGLES

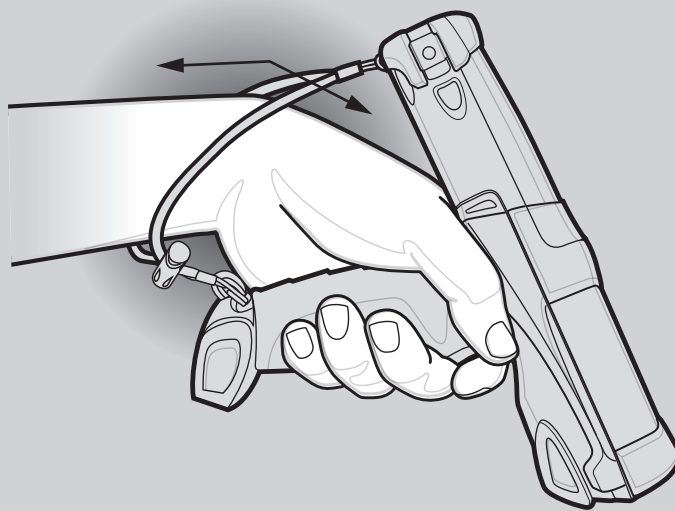

ALTERNATE LEFT AND RIGHT HANDS
TAKING BREAKS AND TASK ROTATION RECOMMENDED

OPTIMUM BODY POSTURE

Low Scanning

Alternate left and right knees

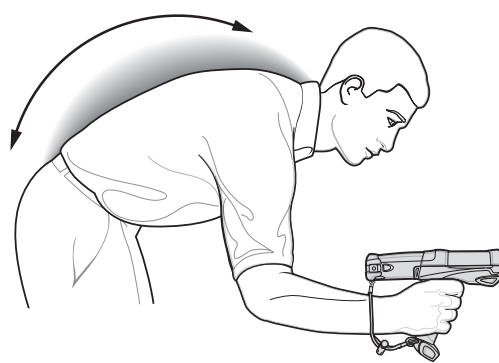

Alternate left and right hands

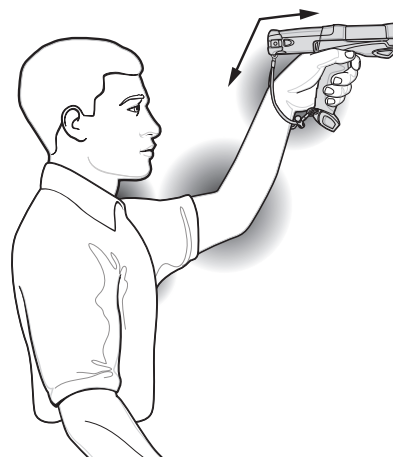

High Scanning

Use a ladder



Taking breaks and task rotation recommended

POST IN WORK AREA



Zebra Technologies Corporation
Lincolnshire, IL U.S.A.
Zebra and the Zebra head graphic are registered trademarks of ZIH Corp. The Symbol logo is a registered trademark of Symbol Technologies, Inc., a Zebra Technologies company.
© 2015 Symbol Technologies, Inc.



72-161751-02 Rev B - April 2015



<http://www.zebra.com/mc92n0-g>