

SETTING UP YOUR MOUSE AND KEYBOARD

STEP 1

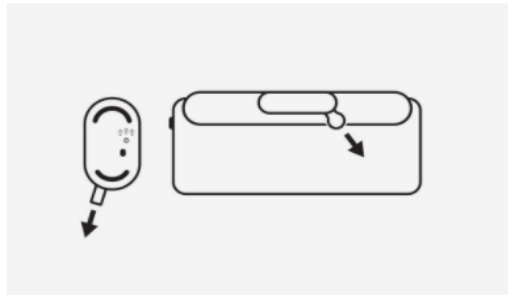

Ready to go? Remove pull-tabs.

Remove the pull-tabs from POP Mouse and the back of POP Keys and they will automatically switch on.

STEP 2: PAIR POP KEYS

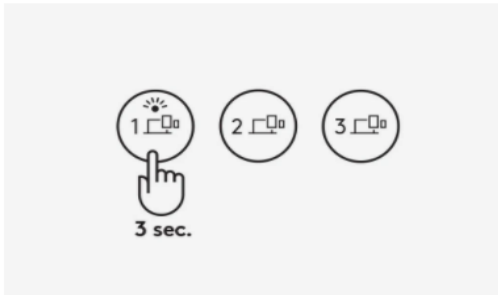

Enter Pairing Mode

Long press (that's about 3 seconds) the Channel 1 Easy-Switch key to enter Pairing Mode. The LED on the keycap will start blinking.

STEP 3: PAIR POP MOUSE

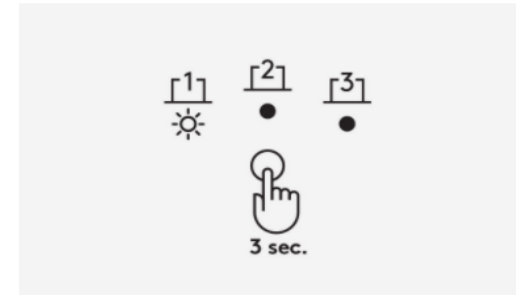

Enter Pairing Mode

Press the button on the bottom of your mouse for 3 seconds. The LED light will start blinking.

STEP 4: CONNECT POP KEYS

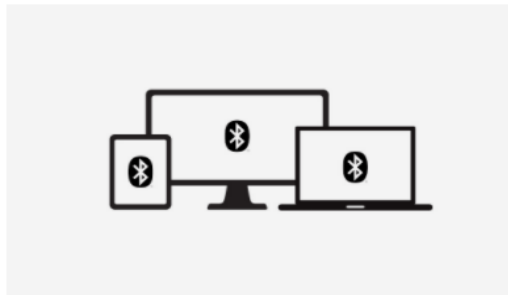

Get your POP Keys connected

Open *Bluetooth* preferences on your computer, phone or tablet. Select "Logi POP" on the list of devices. You should see a PIN code appear on screen. Type that PIN code out on your POP Keys then press the Return or Enter key to finish connecting.

NOTE

Each PIN code is randomly generated. Make sure you enter the one shown on your device.

When using the *Bluetooth* connection (Windows/macOS), your POP Keys' layout will automatically adapt to the settings on your connected device.

STEP 5: CONNECT POP MOUSE

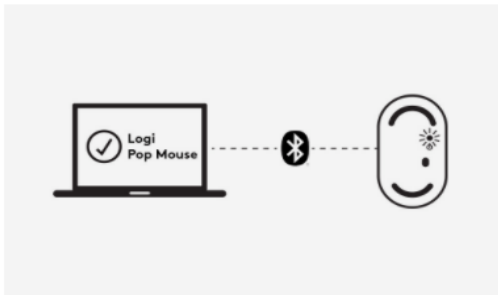

How to connect your POP Mouse

Simply search for your Logi POP Mouse on your device's *Bluetooth* menu. Select, and—ta-da!—you're connected.

ALTERNATIVE WAY TO CONNECT

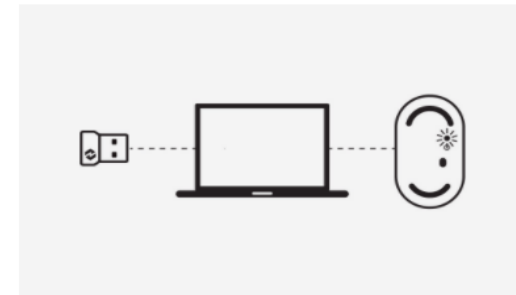

Bluetooth not your thing? Try Logi Bolt.

Alternatively, you can easily connect both devices using the Logi Bolt USB receiver, which you'll find in your POP Keys box. Follow simple Logi Bolt pairing instructions on Logitech Software (which you can download in a flash at [logitech.com/pop-download](https://www.logitech.com/pop-download))

MULTI-DEVICE SETUP

STEP 1

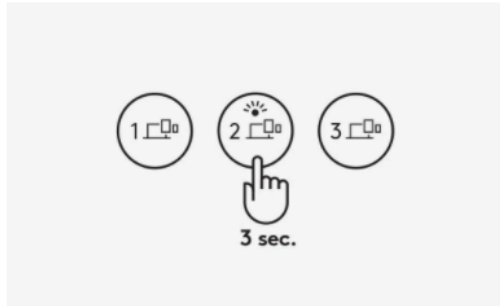

Want to pair with another device?

Easy. Long press (3-ish seconds) the Channel 2 Easy-Switch Key. When the keycap LED starts blinking, your POP Keys is ready to pair to a second device via *Bluetooth*

Pair to a third device by repeating the same thing, this time using the Channel 3 Easy-Switch Key.

STEP 2

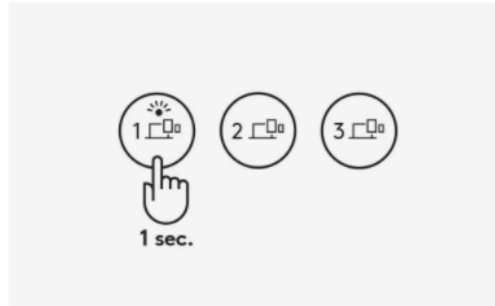

Tap between devices

Simply tap the Easy-Switch keys (Channel 1, 2, or 3) to move between devices as you type.

STEP 3

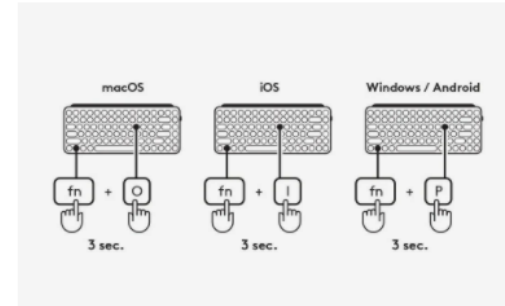

Select a specific OS Layout for your POP Keys

To switch to other OS keyboard layouts, long press the following combinations for 3 seconds:

- FN and "P" keys for Windows/Android
 - FN and "O" keys for macOS
 - FN and "I" keys for iOS

When the LED on the corresponding channel key lights up, your OS has been successfully changed.

HOW TO CUSTOMIZE YOUR EMOJI KEYS

STEP 1

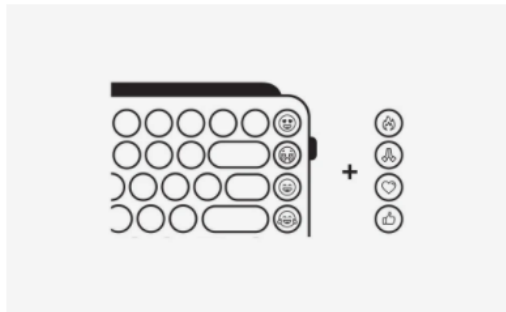

Download Logitech Software to get started

Ready to get playful with your emoji keys? Download Logitech Software from logitech.com/pop-download and follow the easy installation instructions. Once the software is installed, your emoji keys are good to go.

*Emojis are currently supported on Windows and macOS only.

STEP 2

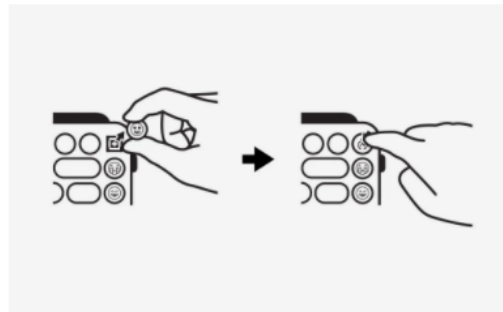

How to swap out your emoji keycaps

To remove an emoji keycap, firmly grip it and pull it vertically. You'll see a little '+' shaped stem beneath.

Choose the emoji keycap you want on your keyboard instead, align it with that little '+' shape, and press down firmly.

STEP 3



Open Logitech software

Open Logitech Software (making sure your POP Keys is connected) and select the key you want to reassign.

STEP 4



Activate the new emoji

Select your favorite emoji from the suggested list, and get your personality popping in chats with friends!

HOW TO CUSTOMIZE YOUR POP MOUSE

STEP 1

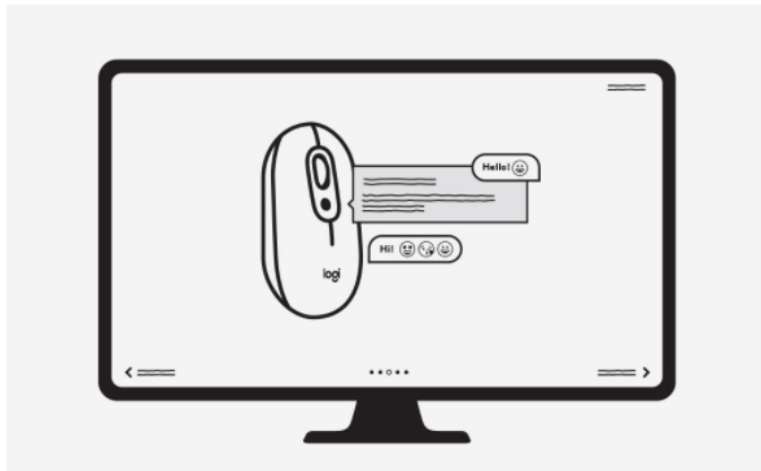

Download Logitech Software

After installing Logitech Software at [logitech.com/pop-download](https://www.logitech.com/pop-download), explore our software and customize the top button of POP Mouse to any shortcut you like.

STEP 2



Change your shortcut across apps

You can even customize your POP Mouse to be app-specific! Just play around and make it your own.

设置鼠标与键盘

第一步

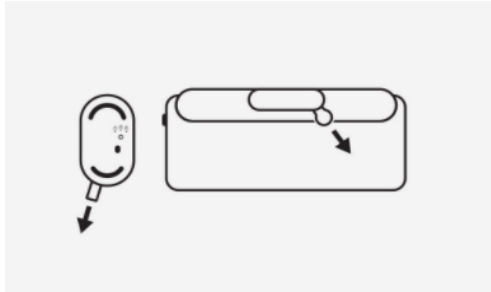

第一步，先移除标签。

从底部拉出标签，POP键盘将会自动启动。拔出贴纸标签，POP鼠标将会自动启动。

第二步：配对POP键盘

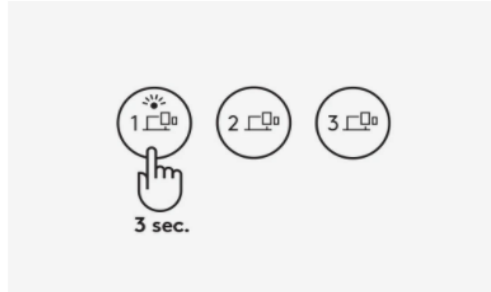

进入配对模式

长按“通道 1”的Easy-Switch按钮3秒钟以进入配对模式，键帽的LED 状态指示灯便会开始闪烁，表示已准备好配对

第二步：配对POP鼠标

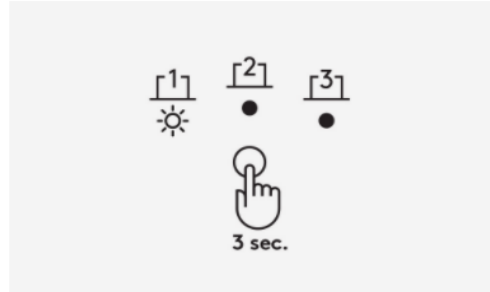

进入配对模式

按住POP鼠标底部的按钮3秒，LED指示灯便会开始闪烁。

第四步：连接POP键盘

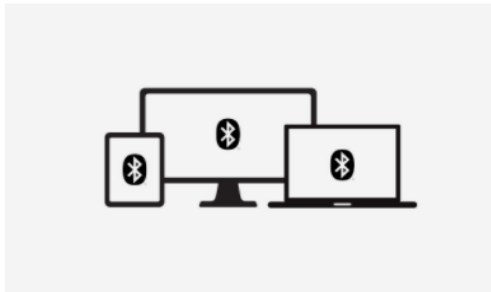

POP键盘: 开始连接

在电脑、手机或者平板电脑上打开蓝牙偏好设置，在设备列表里面选择“Logi POP”，你将会看到屏幕显示代码。在POP键盘上键入代码并按下“确认”或“返回”，即可完成连接。

备注：

由于每一组密码都是随机生成的，请先确认是你的设备上显示的密码再输入。

当你使用蓝牙连接 (Windows/macOS)，POP键盘的布局会自动根据配对设备的设置切换。

第五步：连接POP鼠标

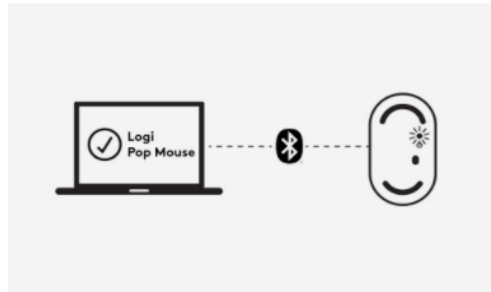

如何连接POP鼠标

在设备上开启蓝牙搜索罗技POP鼠标，即可通过蓝牙连接。轻松一点，配对便完成！

替代连接方式

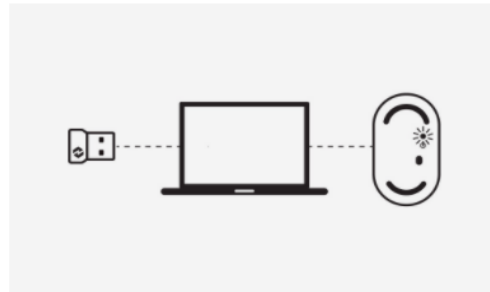

不爱用蓝牙？试试看Logi Bolt吧。

另一个连接方法，就是使用Logi Bolt USB接收器。你可以额外购买接收器，或在你的POP键盘包装盒里找到。[按照罗技Bolt的简单说明，轻松连接。](#)

多设备设置

第一步

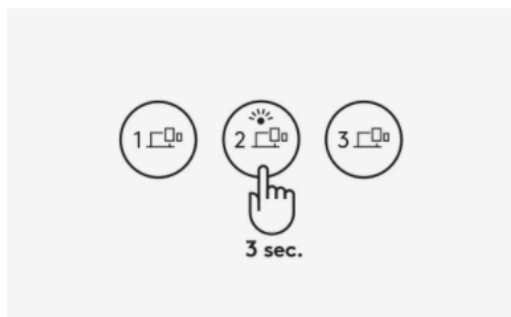

想配对另一台设备？

只要长按“通道 2 “的Easy-Switch “易于切换”按钮3秒钟，当键帽开始闪烁，即代表POP键盘准备好通过蓝牙配对第二台设备。

如果想配对第三台设备，就可以用“通道 3 “的Easy-Switch™ “易于切换” 按钮重复以上操作。

第二步

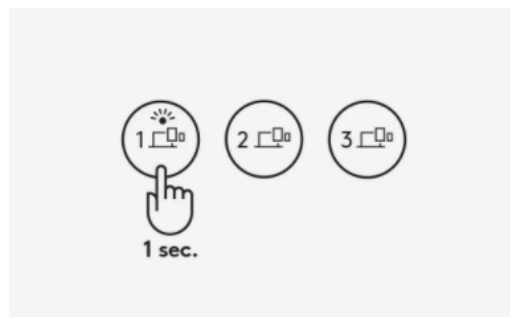

切换设备

只需短按Easy-Switch™ “易于切换键” (通道1、2或3)即可轻松切换设备。

第三步

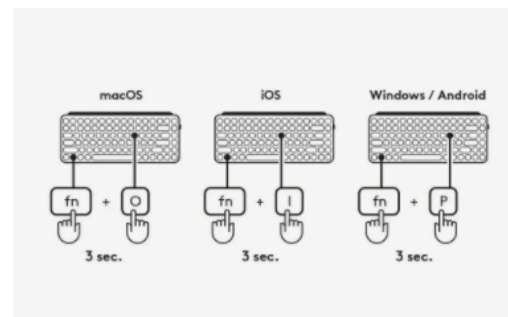

选择特定的OS布局

要切换至其他键盘布局，请长按以下的按键组合3秒：

- Windows/Android - FN和“P”键
 - Mac - FN和“O”键
 - iOS - FN和“l”键

当所选通道的LED指示灯将亮起，表示操作系统已成功更改。

自定义表情包键帽

第一步

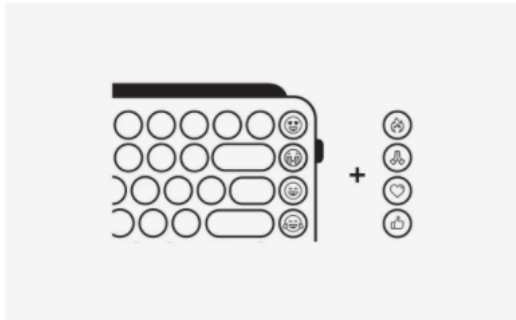

自定POP键盘上的表情包

准备好玩转专属表情包²⁰了吗？马上到 logitech.com/pop-download 下载罗技软件并按照说明安装后，就可以开始自定义。

第二步

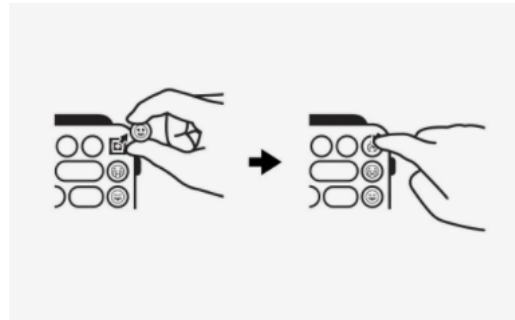

如何切换表情键帽

握紧键帽并垂直往上拔，就能移除表情键帽，看到下面的十字轴。

选择你想放置在键盘上的表情键帽，对准十字轴并按下压紧。

第三步



打开罗技软件

打开罗技软件 (记得先确认连接了POP键盘)，选择你想要重新指定的键帽。

第四步



启动新表情包

然后，你便能从建议列表中选择你最爱的表情，与好友畅快聊天，尽情表达自我！

如何自定义POP鼠标

第一步

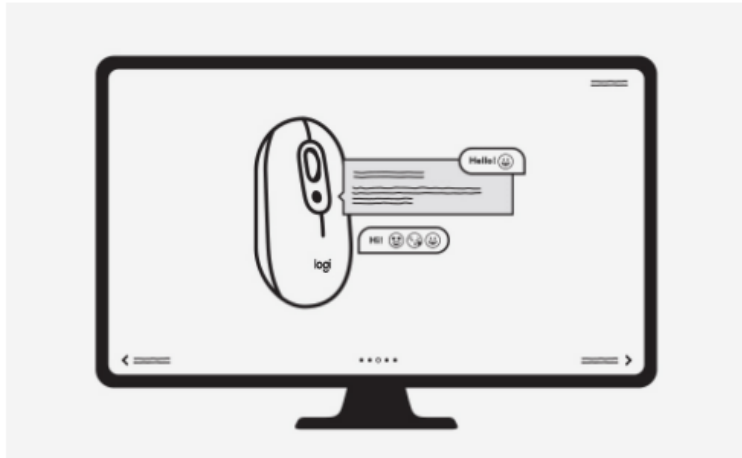

下载罗技软件

从 [logitech.com/pop-download](https://www.logitech.com/pop-download) 下载并安装罗技软件后，你可以尽情探索，把POP鼠标的顶部按钮设置为快捷键。

第二步

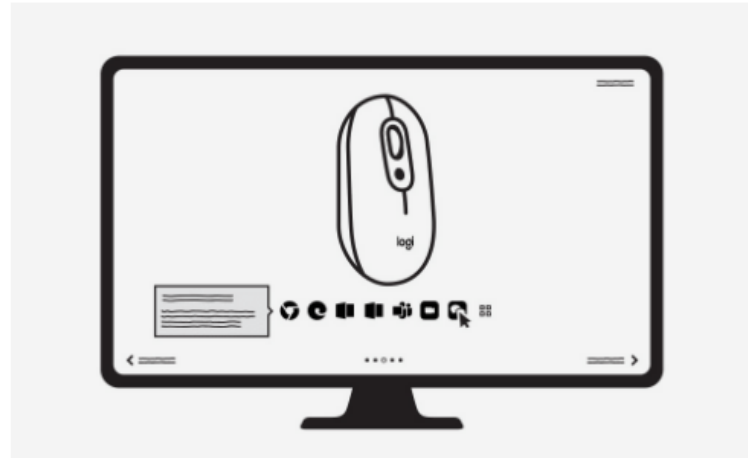

跨程序改捷径

你还可以针对专用应用程序自定义设置。马上挑选你的常用应用程序，设置你的专属POP鼠标吧。