

NEED MORE HELP?

For the latest support info and online User Manuals visit jabra.com/motionoffice
TOLL FREE Customer Contact Details:

NA Support

Email: support.na@jabra.com
Twitter: twitter.com/jabra_US
www.jabra.com/mobilesupport
(For the latest support info
and online user manuals)

1 (800) 327-2230 (U.S.)

1 (800) 489-4199 (Canada)

For more information, please visit
www.jabra.com

Jabra MOTION OFFICE

Jabra[®]
YOU'RE ON

GET STARTED

[JABRA.COM/MOTIONOFFICE](https://jabra.com/motionoffice)

A BRAND BY

GN Netcom

© 2014 GN Netcom A/S (North America: GN Netcom US, Inc.). All rights reserved. Jabra® is a registered trademark of GN Netcom A/S. All other trademarks included herein are the property of their respective owners. The Bluetooth® word mark and logos are owned by the Bluetooth SIG, Inc. and any use of such marks by GN Netcom A/S is under license. (Design and specifications subject to change without notice).

Made in China

MODEL: BTE6
WHB006



www.jabra.com

ENGLISH	2
FRANÇAIS	8
ESPAÑOL	14
PORTUGUÊS	20
日本語	26

This headset has been designed and manufactured to not exceed limits for exposure to radio frequency (RF) energy set by the Federal Communications Commission (FCC) of the U.S. Government and by the Canadian regulatory authorities.

The highest SAR value for this headset when tested for use at the ear is 0.889 W/kg.

For Canada market only: This EUT is compliant with SAR for general

population/uncontrolled exposure limits in IC RSS-102 and had been tested in accordance with the measurement methods and procedures specified in IEEE 1528.

Ce casque a été conçu et fabriqué pour ne pas dépasser les limites d'exposition aux fréquences radio (RF) fixées par la Commission fédérale des communications (Federal Communications Commission - FCC) du gouvernement américain et par les autorités réglementaires canadiennes.

La valeur du DAS la plus élevée pour ce casque lorsque testé pour une utilisation à l'oreille est de 0,889 W/kg.

Pour le marché canadien seulement : ce MAE est conforme aux limites d'exposition DAS incontrôlée pour la population générale de la norme CNR-102 d'Industrie Canada et a été testé en conformité avec les méthodes de mesure et procédures spécifiées dans IEEE 1528.

OVERVIEW

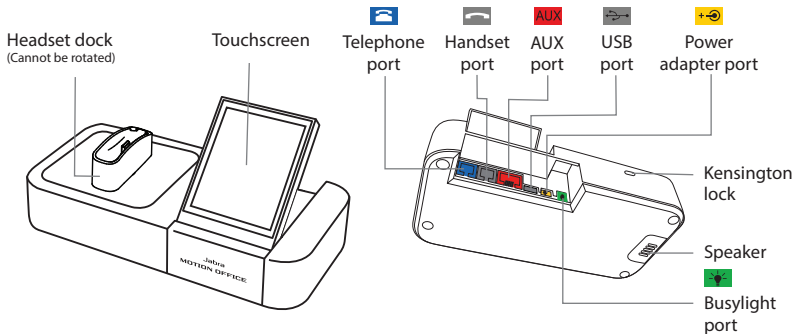
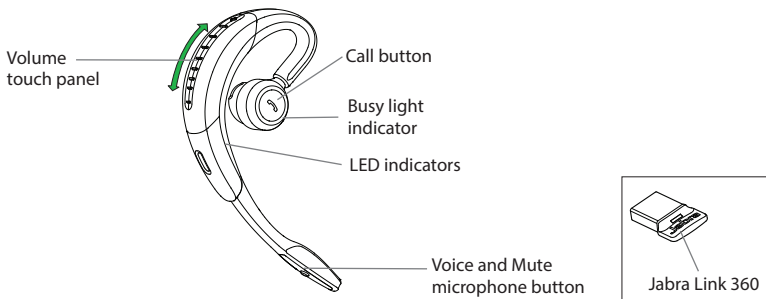

1 BASIC SETUP

ENGLISH

1

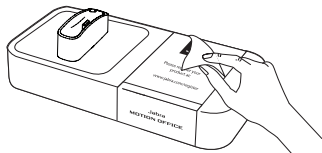

2



3

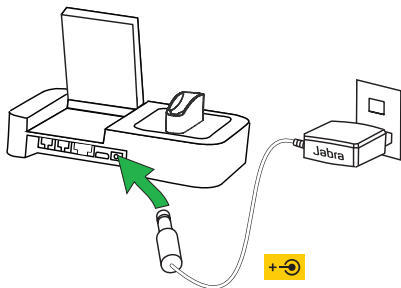

4

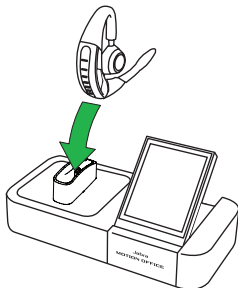

Important!

Download and install the latest Jabra software from jabra.com/pcsuite for full headset functionality.

2 CONNECT TO PHONE OR PC

JABRA MOTION OFFICE CONNECTION

The first time the base is connected to power, the setup wizard will automatically start. The setup wizard can also be accessed at any time via the touchscreen menu.

1. Tap the Settings menu on the touchscreen.
2. Tap Phone settings > Setup wizard.
3. Tap confirm to start the setup wizard.

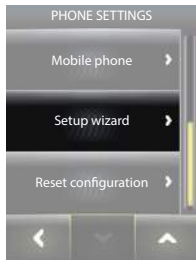

JABRA LINK 360 CONNECTION

The Jabra Link 360 enables a connection to a PC without the base, giving you wireless freedom when you travel.

To connect, simply plug the Jabra Link 360 into a USB port on your PC. The headset and the Jabra Link 360 are already pre-paired.



Important!

The Jabra Link 360 and the base should not be plugged in at the same time.



3 WEARING THE HEADSET

HEIGHT ADJUSTMENT

Get the perfect fit for your ear by adjusting the height of the speaker up or down.

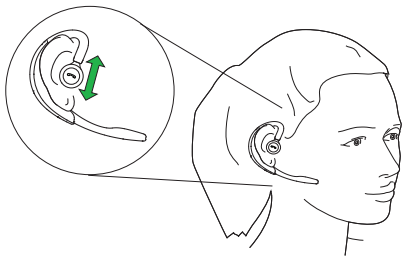

LEFT OR RIGHT EAR WEARING STYLE

The headset can be worn on the left or right ear. To switch ear:

1. Pull the speaker all the way down.
2. Rotate the speaker 180°.
3. Twist the eargel around to fit your ear.

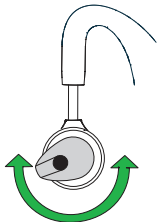
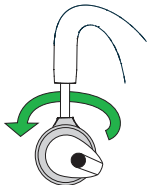
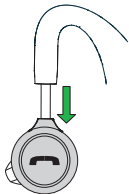

4 HOW TO USE

Volume touch panel

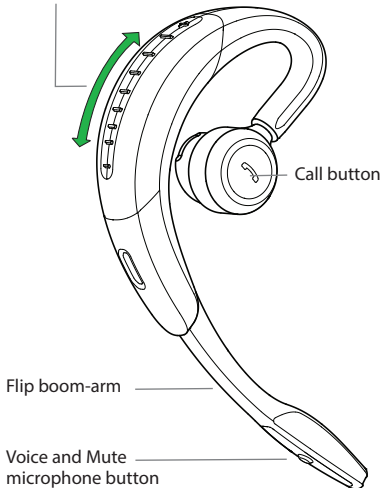

IDLE

Settings menu

Connected devices
(primary device at front)

Initiate call



INCOMING CALL

Answer call

Reject call







ON A CALL

Call options menu

Mute call

End call

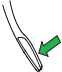
	FUNCTION	ACTION
	Headset On/off	Open/close the flip boom-arm
	Answer call	Tap the Call button on the headset, or tap the Answer call button on the touchscreen
	End call	Tap the Call button on the headset, or tap the End/reject call button on the touchscreen
	Talk time status	When not on a call, tap the Call button on the headset
	Speaker volume	Slide a finger up/down the Volume touch panel
	Switch primary device	Tap a connected device on the touchscreen to switch the primary device for calls
	Voice commands	Tap the Voice and Mute microphone button when not on a call, until you hear 'Say a command'. Say 'What can I say?' for a list of voice commands
	Mute microphone	Tap the Voice and Mute microphone button during a call

Important!

For more information about using the Jabra Motion Office, refer to jabra.com/motionoffice

APERÇU

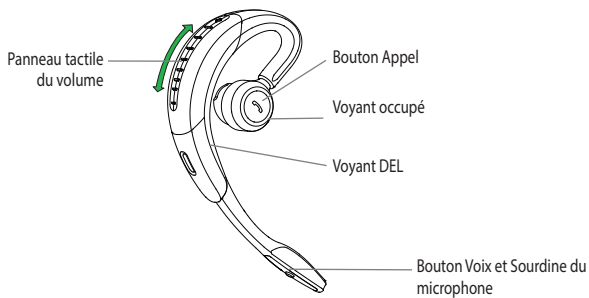

Support de casque
(rotation impossible)

Écran tactile

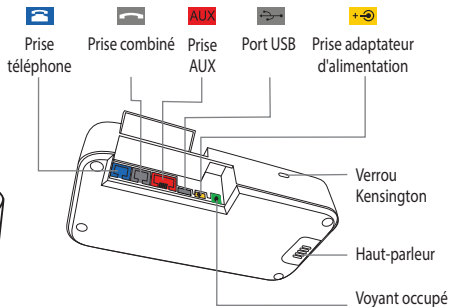

1 CONFIGURATION DE BASE

FRANÇAIS

1

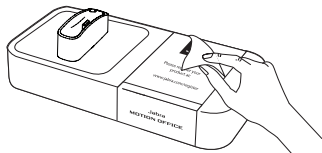

2



3

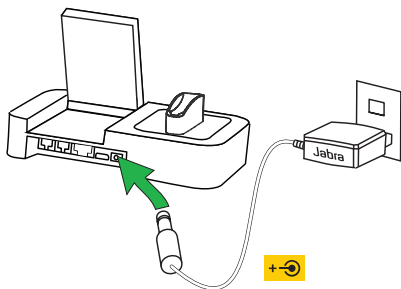

4

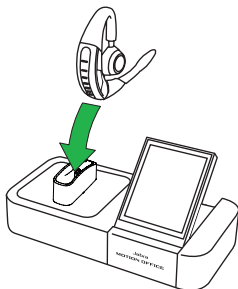

Important!

Pour bénéficier de l'ensemble des fonctionnalités du casque, téléchargez et installez le dernier logiciel Jabra à partir du site jabra.com/pcsuite.

2 CONNEXION AU TÉLÉPHONE/ORDINATEUR

CONNEXION DU JABRA MOTION OFFICE

L'assistant de configuration démarre automatiquement à la première connexion de la base. Il est aussi accessible en permanence par le biais du menu sur l'écran tactile.

1. Sélectionnez le menu Settings (Paramètres) sur l'écran tactile.
2. Sélectionnez Phone settings > Setup wizard (Paramètres du téléphone > Assistant de configuration).
3. Sélectionnez Confirm (Confirmer) pour lancer l'assistant de configuration.

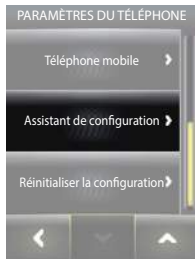

CONNEXION JABRA LINK 360

Avec le Jabra Link 360, il n'est pas nécessaire d'avoir une base pour se connecter à un PC. Vous bénéficiez ainsi d'une liberté sans fil quand vous voyagez.

Pour établir la connexion, il vous suffit de brancher le Jabra Link 360 sur un port USB de votre ordinateur. Le casque et le Jabra Link 360 sont déjà pré-appariés.



Important!

Le Jabra Link 360 et la base ne doivent pas être branchés en même temps.



3 PORT DU CASQUE

AJUSTEMENT DE LA HAUTEUR

Obtenez un confort parfait en ajustant la hauteur du haut-parleur vers le haut ou vers le bas.

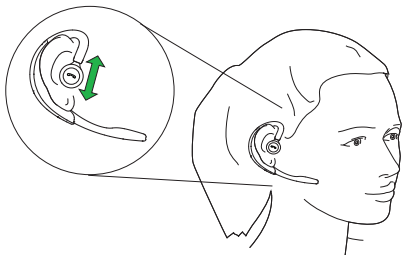

PORT À GAUCHE OU À DROITE

Le casque se porte sur l'oreille gauche ou droite. Pour changer d'oreille :



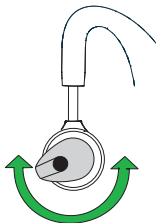
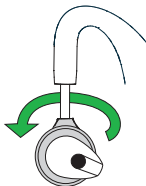
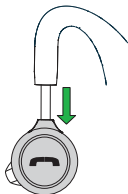

1. Tirez le haut-parleur vers le bas jusqu'au bout.
2. Tournez le haut-parleur de 180 degrés.
3. Tournez l'oreillette pour l'adapter à votre oreille.

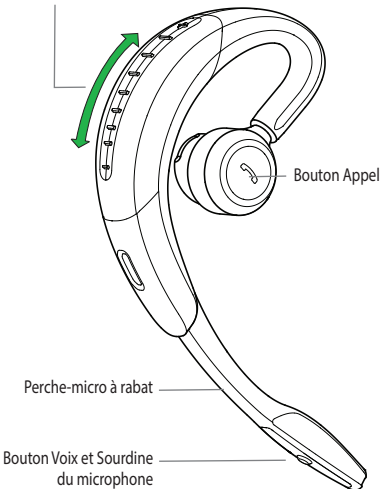

4 COMMENT L'UTILISER

Panneau tactile du volume

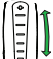

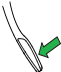
	FONCTION	ACTION
	Casque en Marche/ Arrêt	Ouvrir/Fermer la perche-micro à rabat
	Répondre à un appel	Appuyez sur le bouton Appel du casque ou sur le bouton Répondre à un appel sur l'écran tactile
	Terminer un appel	Appuyez sur le bouton Appel du casque ou sur le bouton Terminer/ Refuser un appel sur l'écran tactile
	État du temps de conversation	Si aucun appel n'est en cours, appuyez sur le bouton Appel du casque
	Volume du haut-parleur	Faites glisser un doigt vers le haut/bas sur le panneau tactile du volume
	Réception des appels sur le périphérique principal	Sur l'écran tactile, sélectionnez un périphérique connecté comme périphérique principal pour réceptionner les appels
	Commandes vocales	Appuyez sur le bouton Voix et Sourdine du microphone lorsqu'il n'y a pas d'appel en cours, jusqu'à ce que vous entendiez l'annonce « Say a command ». Dites « What can I say? » pour obtenir la liste de toutes les commandes vocales
	Mettre le microphone en sourdine	Appuyez sur le bouton Voix et Sourdine du microphone durant un appel

Important!

Pour plus de détails au sujet de l'utilisation de Jabra Motion Office, consultez le site jabra.com/motionoffice

INFORMACIÓN GENERAL

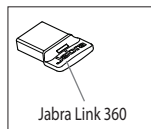
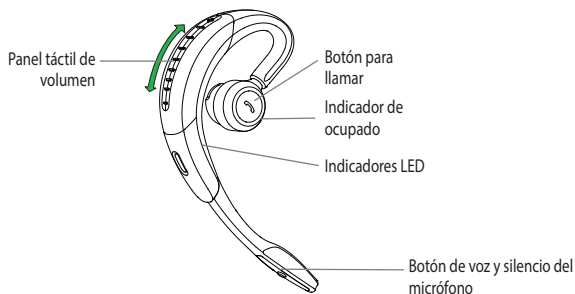

Base de acople del auricular
(no se puede girar)

Pantalla táctil

 Puerto para línea telefónica

 Puerto para el auricular

 Puerto auxiliar

 Puerto USB

 Puerto para el adaptador de alimentación

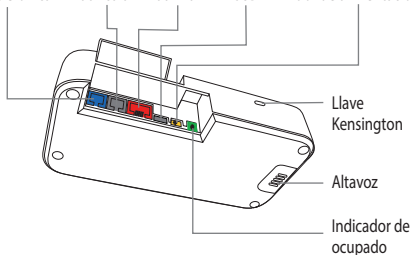
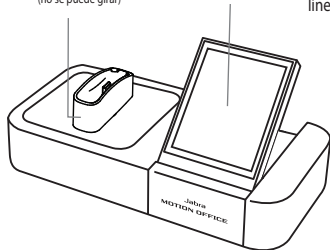

1 CONFIGURACIÓN BÁSICA

ESPAÑOL

1

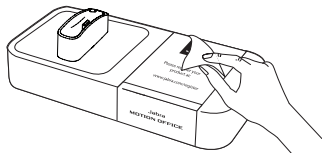

2

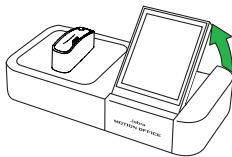

3

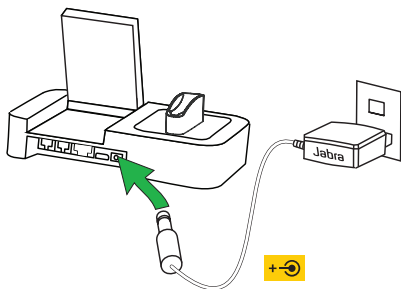

4

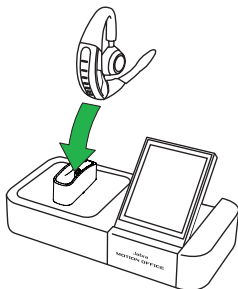

¡Importante!

Descargue e instale el último software de Jabra de jabra.com/pcsuite para obtener las funciones completas del auricular.

2 CONEXIÓN AL TELÉFONO O LA PC

CONEXIÓN DE JABRA MOTION OFFICE

La primera vez que conecte la base a la alimentación eléctrica, el asistente de configuración se iniciará automáticamente. También se puede acceder al asistente de configuración en cualquier momento a través del menú de la pantalla táctil.

1. Pulse Settings Menu (Menú configuración) en la pantalla táctil.
2. Pulse Phone settings > Setup wizard (Configuración del teléfono > Asistente de configuración).
3. Pulse Confirm (Confirmar) para iniciar el asistente de configuración.



CONEXIÓN DE JABRA LINK 360

El Jabra Link 360 permite conectarse a una PC sin la base, lo que le da libertad inalámbrica cuando viaja.

Para conectarse, basta con enchufar el Jabra Link 360 a un puerto USB de su PC. El auricular y el Jabra Link 360 ya están presincronizados.



¡Importante!

El Jabra Link 360 y la base no deben estar conectados al mismo tiempo.



3 ESTILOS DE SUJECIÓN

AJUSTE DE ALTURA

Obtenga el ajuste perfecto para sus orejas ajustando la altura del altavoz hacia arriba o abajo.

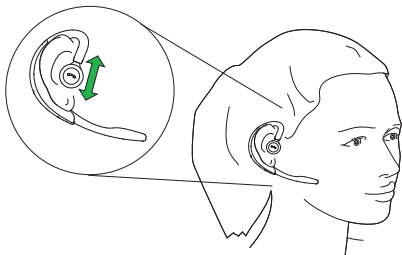

ESTILO DE SUJECIÓN EN EL OÍDO IZQUIERDO O DERECHO

Puede usar el auricular en la oreja izquierda o derecha. Para cambiar de oreja:

1. Jale el altavoz totalmente hacia abajo.
2. Gire el altavoz 180°.
3. Doble el eargel para que se ajuste a su oreja.

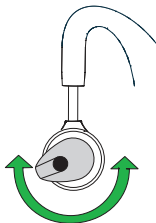
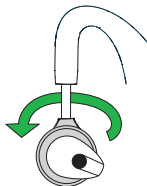
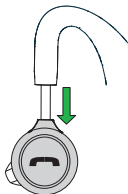

4 CÓMO UTILIZARLO

Panel táctil de volumen

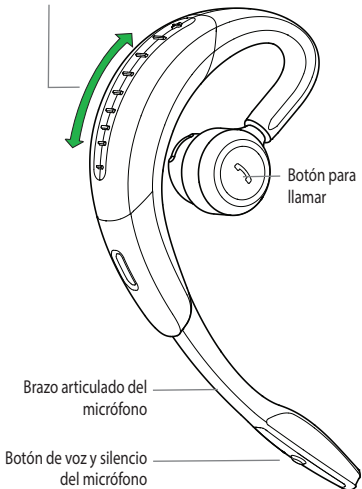





INACTIVO



LLAMADA ENTRANTE

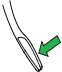

EN UNA LLAMADA

	FUNCIÓN	ACCIÓN
	Auricular Encendido/ Apagado	Abra o cierre el brazo articulado del micrófono
	Responder una llamada	Pulse el botón para Llamar en el auricular o el botón Responder una llamada en la pantalla táctil
	Finalizar una llamada	Pulse el botón para Llamar en el auricular o el botón Finalizar/Rechazar llamadas en la pantalla táctil
	Estado del tiempo de conversación	Cuando no está en una llamada, pulse el botón para Llamar en el auricular
	Volumen del altavoz	Deslice un dedo hacia arriba o abajo en el panel táctil de Volumen
	Cambiar al dispositivo principal	Pulse en un dispositivo conectado en la pantalla táctil para cambiar el dispositivo principal para las llamadas
	Comandos de voz	Pulse el botón de Voz y Silencio del micrófono cuando no esté en una llamada, hasta que escuche "Say a command". Diga "¿What can I say?" para obtener una lista de comandos de voz
	Silenciar el micrófono	Pulse el botón de Voz y Silencio del micrófono durante una llamada

¡Importante!

Para obtener más información acerca del uso de Jabra Motion Office, consulte jabra.com/motionoffice

VISÃO GERAL

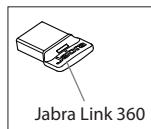
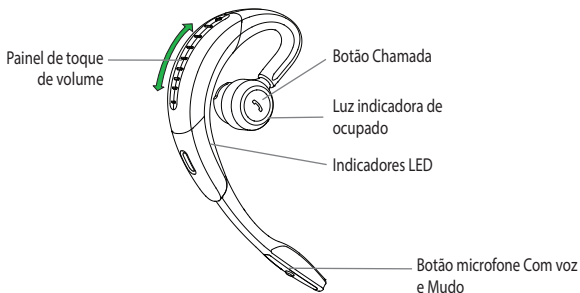

Suporte do fone de ouvido
(Não pode ser girado)

Tela Touchscreen

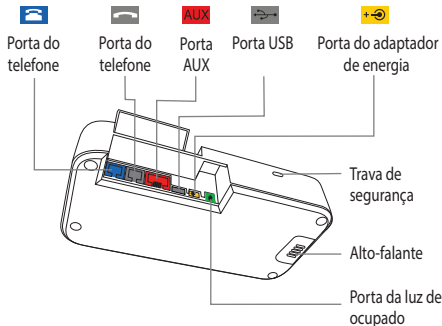
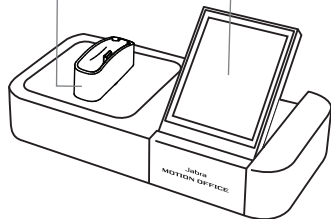

1 CONFIGURAÇÃO BÁSICA

PORTUGUÊS

1

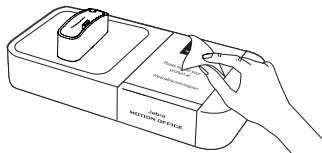

2



3

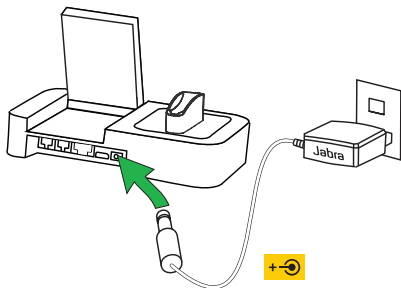

4

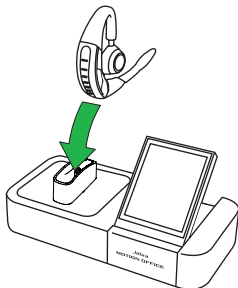

Importante!

Baixe e instale o último software Jabra em jabra.com/pcsuite para todos os recursos do fone de ouvido.

2 CONECTE AO TELEFONE OU PC

CONEXÃO DO JABRA MOTION OFFICE

A primeira vez que a base é conectada à eletricidade, o assistente de configuração iniciará automaticamente. O assistente de configuração também pode ser acessado a qualquer momento através do menu na tela touchscreen.

1. Toque no menu Settings (Configurações) na tela touchscreen.
2. Toque em Phone settings (Configurações do telefone) > Setup wizard (Assistente de configuração).
3. Toque em Confirm (Confirmar) para iniciar o assistente de configuração.

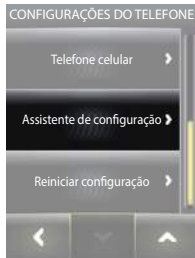

CONEXÃO DO JABRA LINK 360

O Jabra Link 360 permite uma conexão a um PC sem a base, permitindo liberdade sem fio quando você viaja.

Para conectar, basta conectar o Jabra Link 360 em qualquer porta USB no seu PC. O fone de ouvido e o Jabra Link 360 já estão previamente pareados.



Importante!

O Jabra Link 360 e a base não devem ser conectados ao mesmo tempo.



3 COLOCANDO O FONE DE OUVIDO

AJUSTE DA ALTURA

Ajuste-o perfeitamente à sua orelha regulando a altura do alto-falante para cima ou para baixo.

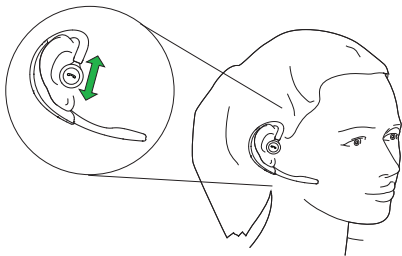

ESTILO DE USO NA ORELHA ESQUERDA OU DIREITA

O fone de ouvido pode ser usado na orelha esquerda ou direita. Para trocar de orelha:

1. Puxe o alto-falante todo para baixo.
2. Gire o alto-falante 180°.
3. Vire o silicone para ajustar ao redor da sua orelha.

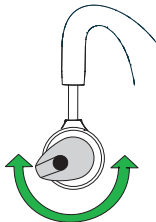
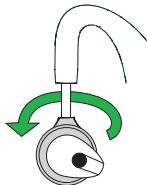
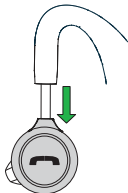

4 COMO USAR

Volume Painel de toque

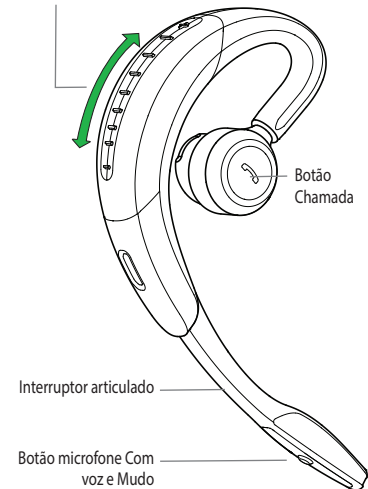

OCIOSO

Menu configuração

Dispositivos conectados (dispositivo primário na frente)

Iniciar uma chamada



CHAMADA RECEBIDA

Atender uma chamada

Recusar uma chamada







EM CHAMADA

Menu de opções de chamada

Tirar o som da chamada

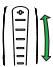
Encerrar uma chamada

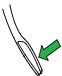
	FUNÇÃO	AÇÃO
	Ligar/desligar o fone de ouvido	Abrir/fechar o interruptor articulado
	Atender uma chamada	Toque o botão Chamada no fone de ouvido, ou toque o botão Atender uma chamada na tela touchscreen
	Encerrar uma chamada	Toque o botão Chamada no fone de ouvido, ou toque o botão Encerrar/recusar chamada na tela touchscreen
	Status de tempo de conversa	Quando não estiver em uma chamada, toque o botão Chamada no fone de ouvido
	Volume do alto-falante	Deslize um dedo para cima e para baixo no painel sensível ao toque de Volume
	Trocar dispositivo primário	Toque em um dispositivo primário na tela touchscreen para trocar o dispositivo primário para chamadas
	Comandos de voz	Toque o botão microfone Com Voz e Mudo quando não estiver em uma chamada, até ouvir 'Say a command'. Fale 'What can I say?' para ouvir uma lista de comandos de voz
	Microfone mudo	Toque o botão microfone Com Voz e Mudo durante uma chamada

Importante!

Para mais informações sobre como usar o Jabra Motion Office, consulte jabra.com/motionoffice

概要

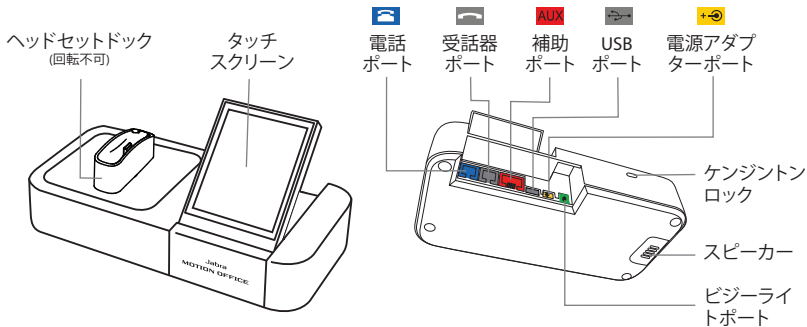
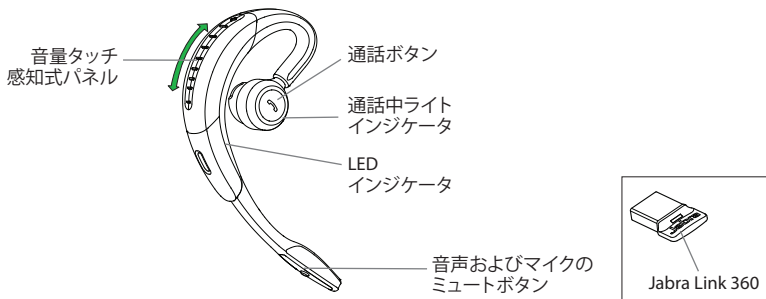

1 基本的な設定

①

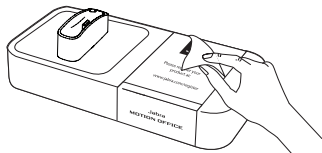

②



③

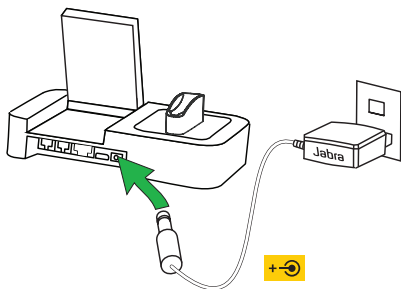

④

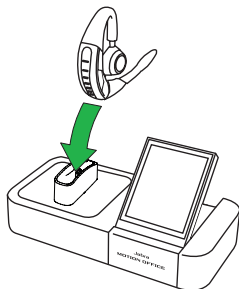

重要!

すべてのヘッドセットの機能が利用できるように、jabra.com/pcsuite から最新の Jabra ソフトウェアをダウンロード/インストールしてください。

2 電話または PC への接続

JABRA MOTION OFFICE の接続

まずはじめにベースを電源に接続すると、セットアップウィザードが自動的に開始されます。セットアップウィザードには、タッチスクリーンメニュー経由で随時アクセスできます。

1. タッチスクリーンで [設定] メニューを軽く押します。
2. [電話設定] > [セットアップウィザード] を軽く押します。
3. [確認] を軽く押して、セットアップウィザードを開始します。



JABRA LINK 360 の接続

Jabra Link 360 があればベースなしで PC に接続できるため、旅行中にワイヤレスの自由をもたらします。

接続するには、PC上の USB ポートに Jabra Link 360 を差し込みます。ヘッドセットと Jabra Link 360 はあらかじめペアリングされています。



重要!

Jabra Link 360 およびベースを同時に接続することはできません。



3 ヘッドセットの装着

高さの調整

スピーカーの高さを上下に調整することで、耳にぴったり合った装着ができます。

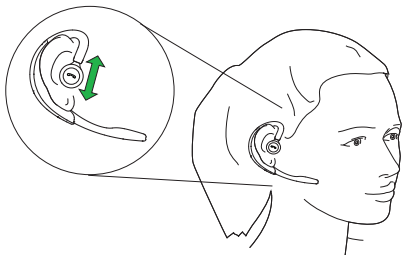

左耳または右耳の装着スタイル

ヘッドセットは左右どちらの耳でも使用できます。左右を切り替えるには、次の手順に従います。

1. スピーカーを下に引っ張ります。
2. スピーカーを180°回転させます。
3. フィットするように、eargel をねじります。

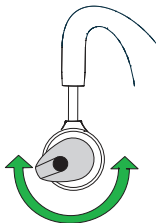
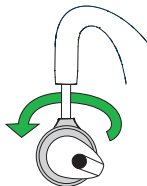
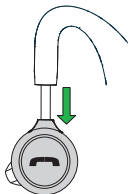

4 使用方法

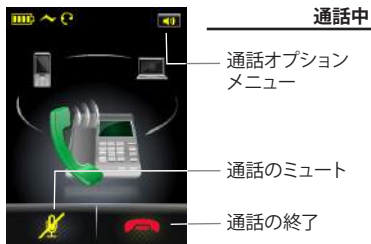
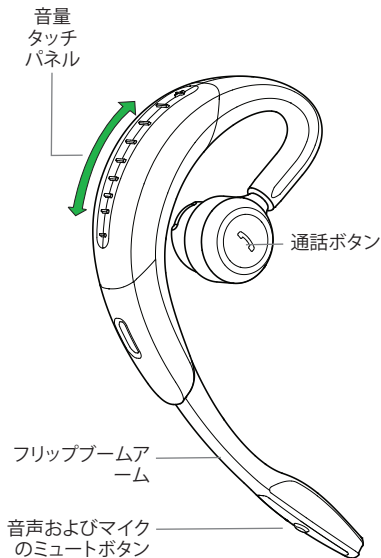

機能	機能	処置
	ヘッドセットのオン/オフ	フリップブームアームの開閉
	通話への応答	ヘッドセットで 通話 ボタンを軽く押すか、タッチスクリーンで 通話への応答 ボタンを軽く押します。
	通話の終了	ヘッドセットで 通話 ボタンを軽く押すか、タッチスクリーンで 通話の終了/拒否 ボタンを軽く押します。
	通話時間ステータス	通話中でない状態で、ヘッドセットの 通話 ボタンを軽く押します。
	スピーカーの音量	音量タッチ感知式パネル で指を上下になぞるようにスライドさせます。
	一次デバイスの切り替え	通話用の一次デバイスを切り替えるは、タッチスクリーン上の接続デバイスを軽く押します。
	音声コマンド	通話中でない場合は 音声およびマイクのミュート ボタンを「コマンドを言ってください」という指示が聞こえるまで軽く押します。音声コマンドの一覧を聞くには、「何と云った方がいいですか?」と言います。
	マイクのミュート	通話中は 音声およびマイクのミュート ボタンを軽く押します。

重要!

Jabra Motion Office の使用に関する詳細は、jabra.com/motionoffice をご参照ください。