



RAZER ANZU

MASTER GUIDE

Rethink eyewear with the **Razer Anzu**—cutting-edge audio glasses that protect your eyes and immerse your ears. With built-in speakers hidden in its frame, taking in the sights and sounds now has a whole new meaning. Available in two types of frames and two sizes.

# CONTENTS

1. WHAT'S INSIDE / WHAT'S NEEDED .....	3
2. LET'S GET YOU COVERED .....	5
3. GETTING STARTED .....	6
4. USING YOUR SMART GLASSES .....	8
5. SAFETY AND MAINTENANCE .....	12
6. LEGALESE.....	13

---

## 1. WHAT'S INSIDE / WHAT'S NEEDED

### WHAT'S INSIDE

- Razer Anzu

*Frame styles may vary per model.*

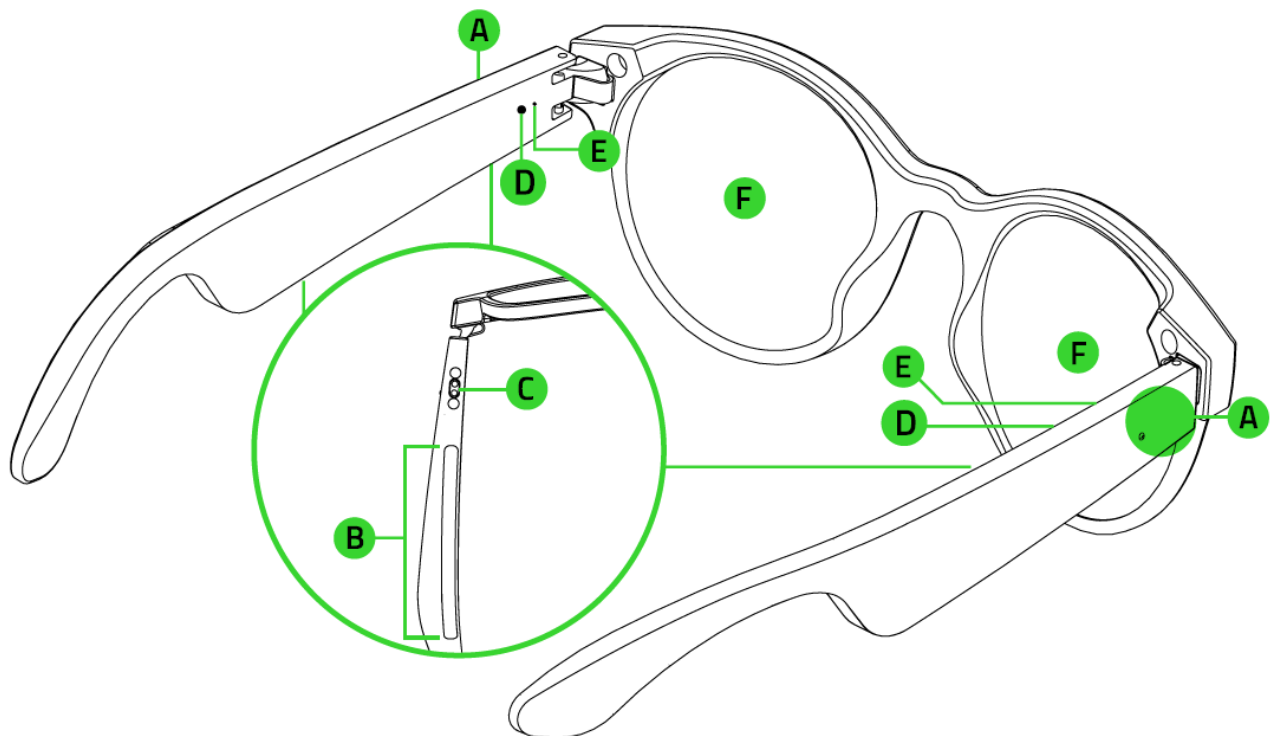

- A. Touch input areas
- B. Built-in speakers
- C. Charging ports
- D. Status indicators

- E. Omnidirectional microphones
- F. Blue light filtering or polarized sunglass lenses\*



\*Scan the QR code or visit [support.razer.com](https://support.razer.com) for an in-depth guide in replacing the installed lenses of your smart glasses.

- Charging cable

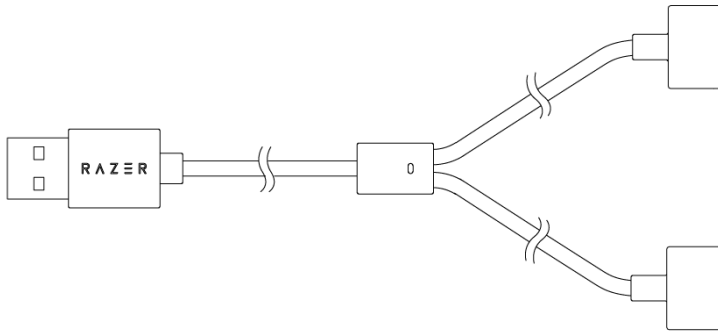

- Glasses case

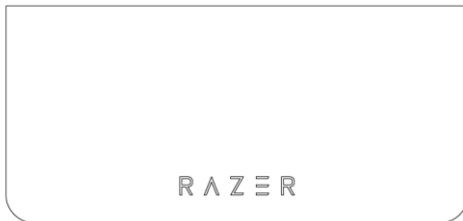

- Cleaning cloth



- Important Product Information Guide

## WHAT'S NEEDED

### PRODUCT REQUIREMENTS

- Devices with Bluetooth audio capability

### RAZER AUDIO APP REQUIREMENTS

- iOS 12 / Android 8.1 Oreo (or higher) device with Bluetooth connectivity
- Internet connection for app installation

---

## 2. LET'S GET YOU COVERED

You've got a great device in your hands, complete with a 2-year limited warranty coverage. Now maximize its potential and score exclusive Razer benefits by registering at [razerid.razer.com](https://razerid.razer.com)

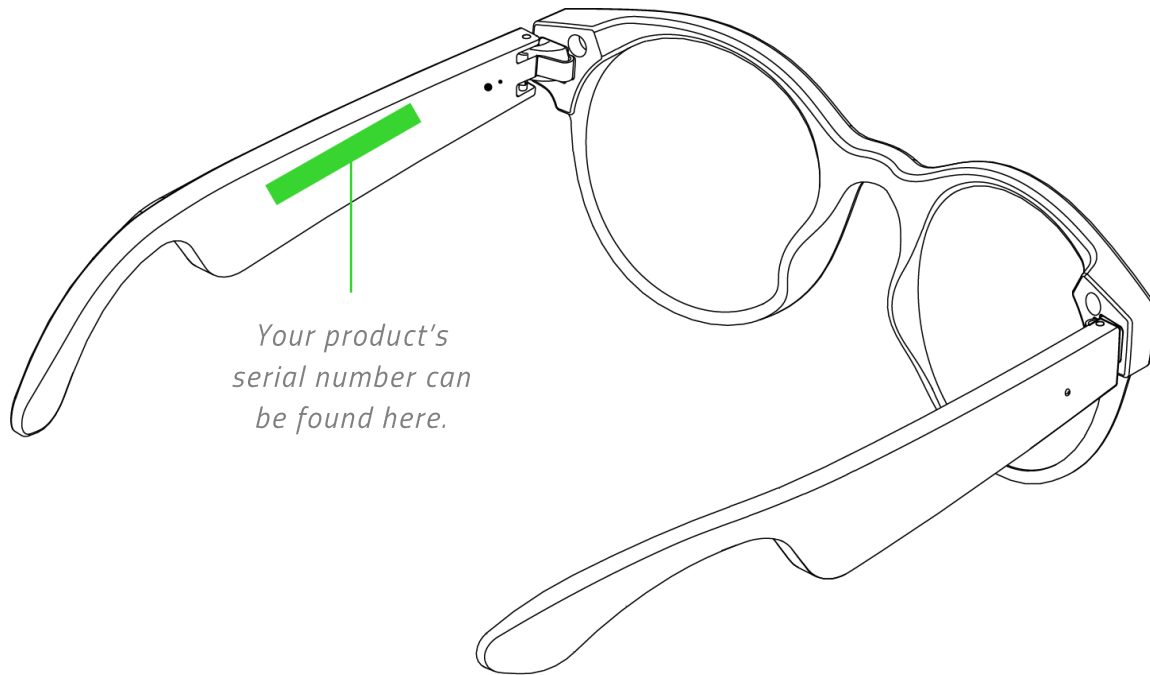

Got a question? Ask the Razer Support Team at [support.razer.com](https://support.razer.com)

---

### 3. GETTING STARTED

#### CHARGING YOUR RAZER ANZU

For first time use, attach the charging cable's pin connectors to the charging ports found at the bottom of each temple and connect the charging cable to a USB port. For best results, please fully charge your glasses before using it for the first time. A depleted device will fully charge in about 1.5 hours.

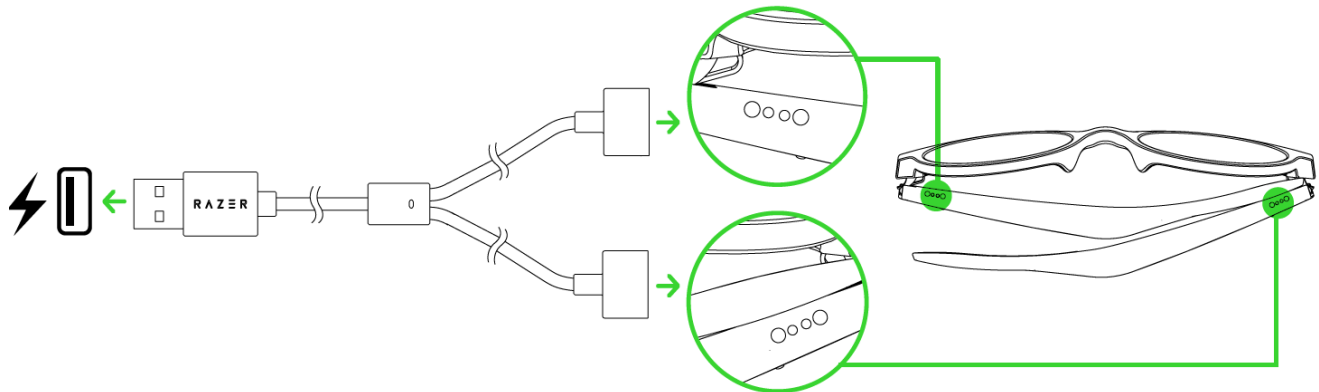

While charging, your Razer Anzu will continuously show its battery level on both indicators, as shown here:

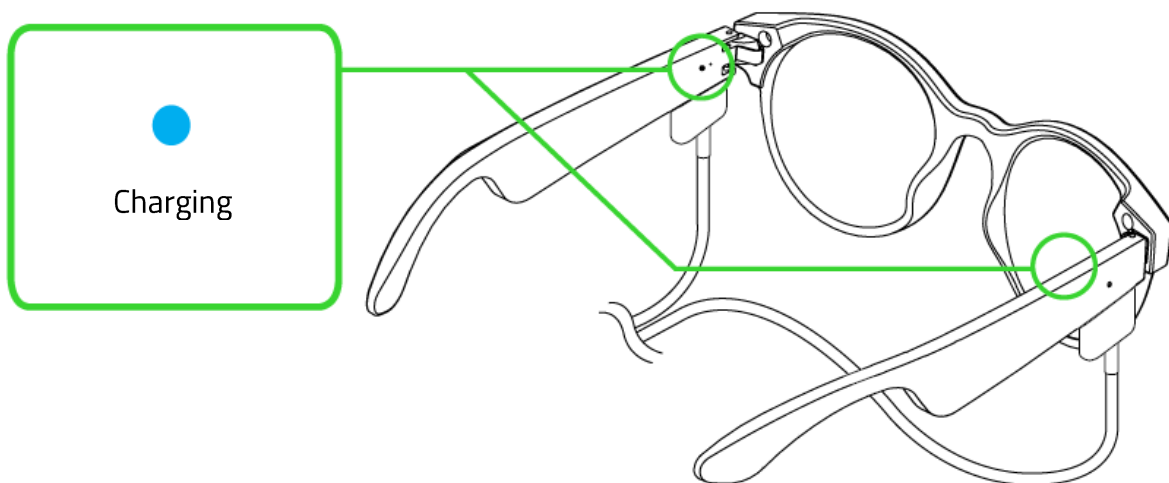

## PAIRING TO A MOBILE DEVICE

Open both temples to power on and activate pairing mode. An audio prompt will notify you that your glasses are searching for compatible Bluetooth devices and its status indicators will rapidly blink in blue. Follow your device's instructions to pair it with your Razer Anzu. Once paired, its status indicators will briefly change to static blue.

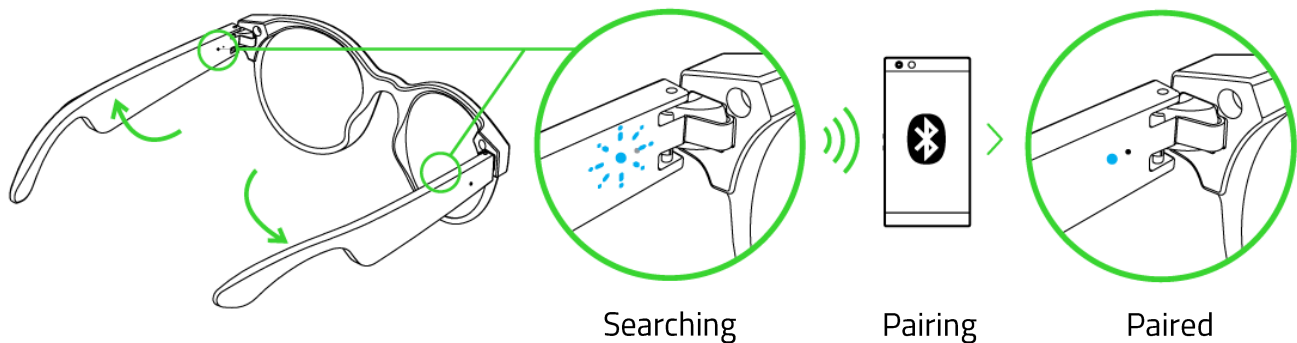

- i** *Once the glasses have been paired, it will automatically try to connect to that paired mobile device every time the glasses are powered on. Your glasses can only connect to one mobile device at a time but will recall pairing for up to 6 devices.*



---

## 4. USING YOUR SMART GLASSES

### RAZER AUDIO APP

Advanced customization just got a whole lot easier for your Razer Anzu. With the Razer Audio app, learn and customize the needed gestures, select from predefined EQs, enable or disable Gaming Mode and much more —anytime, anywhere.

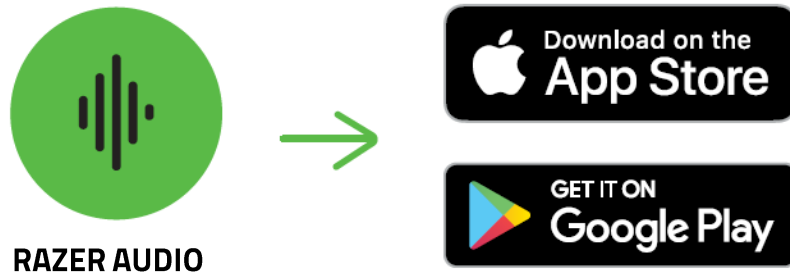

1. Download the mobile app on your mobile device.
2. Launch the app and follow the onscreen instructions.

### POWER ON/OFF

To power off the glasses, close both temples. Opening both temples will power it on. An audio prompt will help notify you that your Razer Anzu is powered on or off.

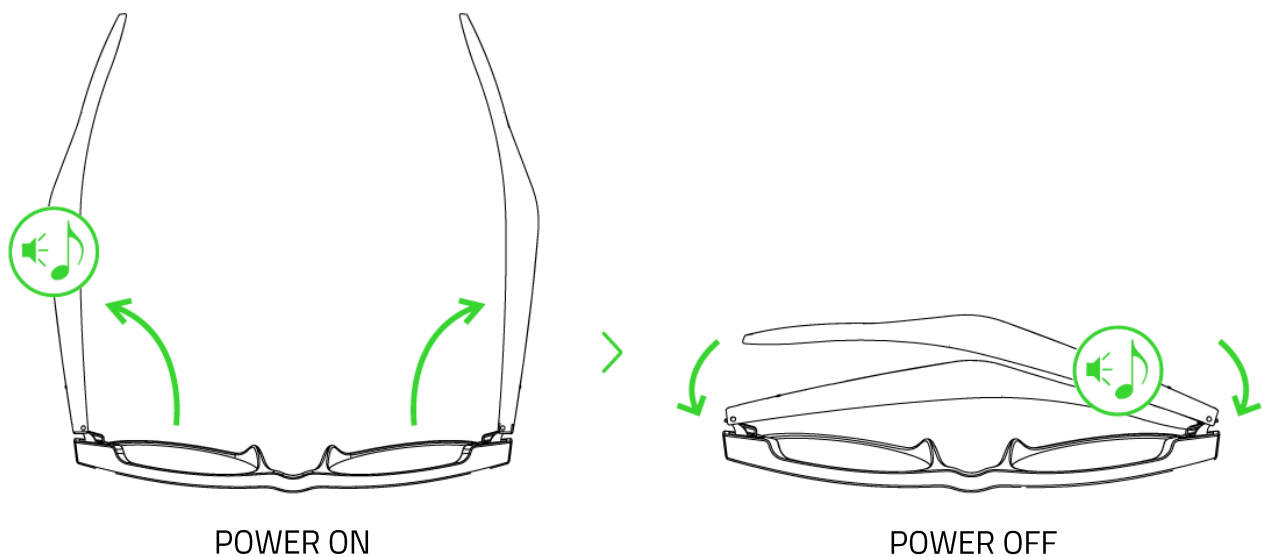

## AUTO SHUTOFF

If the glasses are unable to reconnect with your device and/or left unpaired for a few minutes, you will hear an audio prompt and then the glasses will power off. To wake, simply close and open both temples again.

## GAMING MODE

While connected, triple tap then hold the last tap for at least 2 seconds on any of the touch input areas to activate Gaming Mode. Once enabled, your glasses will function at a lower latency; giving you real-time audio feedback while gaming. Repeat the same gesture to disable Gaming Mode.

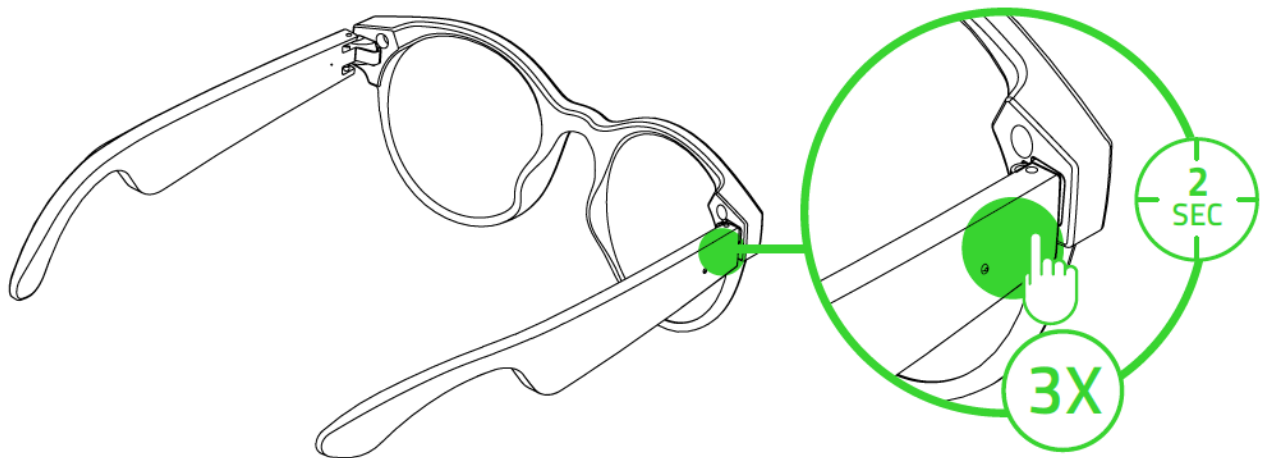

## PAIRING OPTIONS

### Activating Pairing Mode

If you want to pair the glasses to a different device, tap and hold any of the touch input areas for 4 seconds to activate pairing mode. An audio prompt will notify you that your glasses are searching for compatible Bluetooth devices. Simply follow the new device's instructions to pair it with your Razer Anzu.

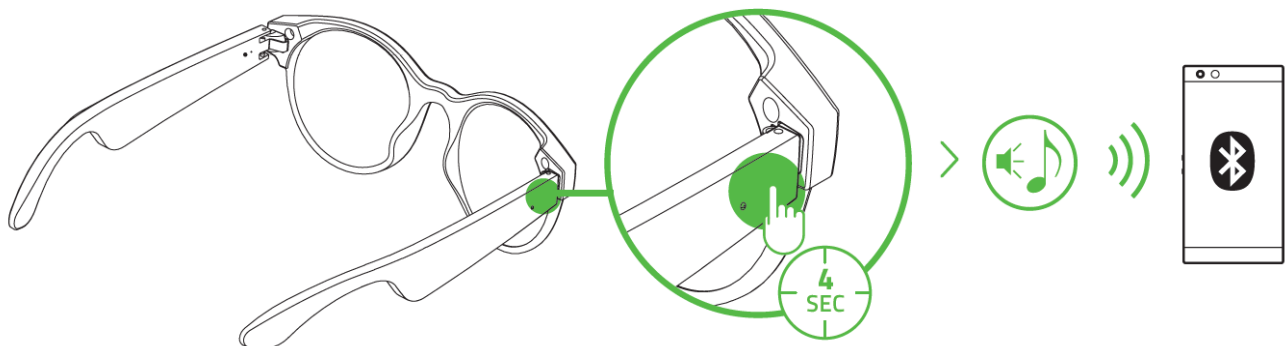

## Removing a Paired Device

Use this option if you want to remove a paired device including all custom gestures. While in pairing mode, triple tap then hold the last tap for at least 2 seconds on any of the touch input areas to remove a paired device and its settings. An audio prompt will notify you that your glasses have removed a device and are searching again for compatible Bluetooth devices. Simply follow the new device's instructions to pair it with your Razer Anzu.

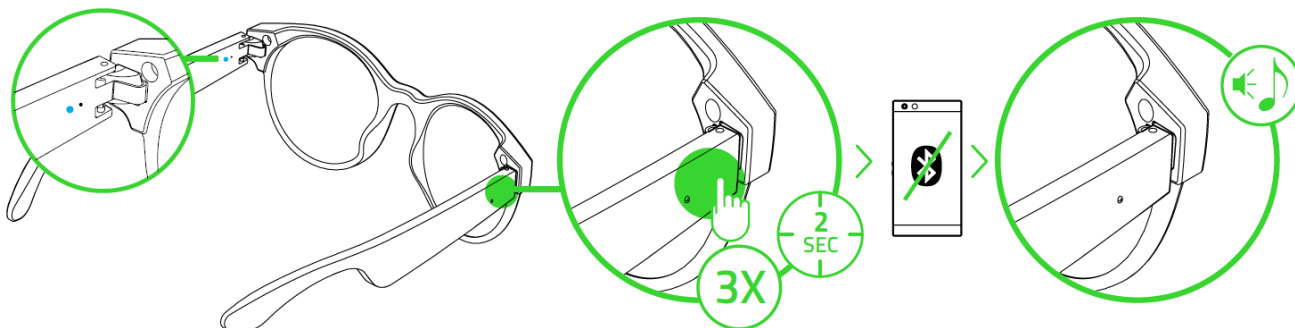

## LOW BATTERY

While unplugged, the status indicators will slowly blink in blue to indicate that the glasses need recharging. This sequence will repeat until the battery is drained or the glasses are being charged.

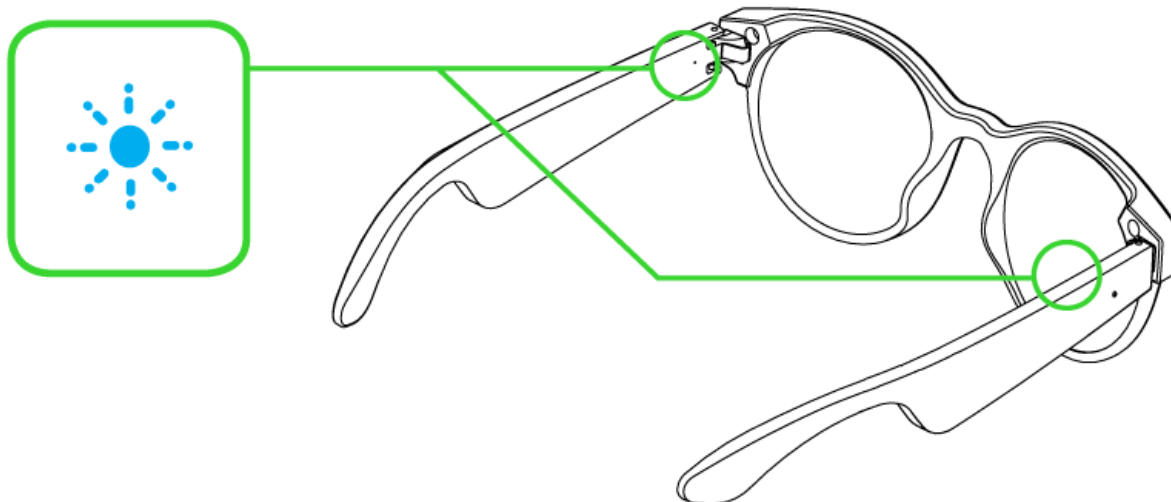

## TOUCH INPUT QUICK REFERENCE

The following functions can be accessed from any of the touch input areas and are only available when the glasses are paired to a mobile device.

ACTION	EFFECT	AUDIO PROMPT
Tap	Answer call	Tone
	End call	Tone
	Play/pause media	Tone
Tap and hold for 2 seconds	Reject incoming call	Tone
	Activate virtual assistant	Tone
Tap and hold for 4 seconds	Activate pairing mode	Voice
Double tap	Accept incoming call or switch calls	Tone
	Skip to the next track when playing media	Tone
Triple tap	Return to the previous track when playing media	Tone
Triple tap then hold the last tap for 2 seconds	Enable/disable Gaming Mode when on standby or playing media	None
	When in pairing mode, this will remove a paired device, its app settings, and re-activate pairing mode	Voice

---

## 5. SAFETY AND MAINTENANCE

### SAFETY GUIDELINES

In order to achieve maximum safety while using your Razer Anzu, we suggest that you adopt the following guidelines:

Should you have trouble operating the device properly and troubleshooting does not work, unplug the device and contact the Razer hotline or go to [support.razer.com](https://support.razer.com) for assistance.

Do not take apart the device and do not attempt to operate it under abnormal current loads. Doing so will void your warranty.

Handle the glasses with care. Do not bend or expose the temples to undue pressure.

Keep the device away from liquid, humidity or moisture. Operate the device only within the specific temperature range of 0°C (32°F) to 40°C (104°F). Should the temperature exceed this range, unplug and/or switch off the device in order to let the temperature stabilize to an optimal level.

Listening to excessively loud volumes over extended periods of time can damage your hearing. Furthermore, legislation of certain countries permits a maximum sound level of 86db to affect your hearing for 8 hours a day. We therefore recommend that you reduce the volume to a comfortable level when listening for prolonged periods of time. Please, take good care of your hearing.

### MAINTENANCE AND USE

The Razer Anzu requires minimum maintenance to keep it in optimum condition. Once a month we recommend you clean it using a soft cloth or cotton swab to prevent dirt buildup. Do not use soap, harsh cleaning agents, or abrasives.

---

## 6. LEGALESE

### **COPYRIGHT AND INTELLECTUAL PROPERTY INFORMATION**

©2021 Razer Inc. All rights reserved. Razer, the triple-headed snake logo, Razer logo, and “For Gamers. By Gamers.” are trademarks or registered trademarks of Razer Inc. and/or affiliated companies in the United States or other countries. All other trademarks are the property of their respective owners.

©2018 Google LLC All rights reserved. Android, Google, Google Logo, Google Play, and the Google Play logo are registered trademarks of Google LLC.

Apple, the Apple logo, and iPhone are trademarks of Apple Inc., registered in the U.S. and other countries. App Store is a service mark of Apple Inc.

The Bluetooth® word mark and logos are registered trademarks owned by Bluetooth SIG, Inc., and any use of such marks by Razer is under license.

Razer Inc. (“Razer”) may have copyright, trademarks, trade secrets, patents, patent applications, or other intellectual property rights (whether registered or unregistered) concerning the product in this guide. Furnishing of this guide does not give you a license to any such copyright, trademark, patent or other intellectual property right. The Razer Anzu (the “Product”) may differ from pictures whether on packaging or otherwise. Razer assumes no responsibility for such differences or for any errors that may appear. Information contained herein is subject to change without notice.

### **LIMITED PRODUCT WARRANTY**

For the latest and current terms of the Limited Product Warranty, please visit [razer.com/warranty](https://www.razer.com/warranty).

### **LIMITATION OF LIABILITY**

Razer shall in no event be liable for any lost profits, loss of information or data, special, incidental, indirect, punitive or consequential or incidental damages, arising in any way out of distribution of, sale of, resale of, use of, or inability to use the Product. In no event shall Razer’s liability exceed the retail purchase price of the Product.

### **GENERAL**

These terms shall be governed by and construed under the laws of the jurisdiction in which the Product was purchased. If any term herein is held to be invalid or unenforceable, then such term (in so far as it is invalid or unenforceable) shall be given no effect and deemed to be excluded without

invalidating any of the remaining terms. Razer reserves the right to amend any term at any time without notice.